

DEPARTMENT OF THE ARMY TECHNICAL MANUAL

General Support Maintenance Repair Parts and Special Tools List  
 (Includes Depot Maintenance Repair Parts and Special Tools)

FOR

TEST SET, AUTOMATIC DIRECTION FINDER

AN/ARM-93

Headquarters, Department of the Army, Washington, D.C.

30 March 1973

Current as of 7 November 1972

		Paragraph	Page
SECTION	I.	INTRODUCTION . . . . .	1
		Scope . . . . .	1
		General . . . . .	1
		Explanation of columns . . . . .	1
		Special information . . . . .	2
		How to locate repair parts. . . . .	2
		Federal supply code. . . . .	3
		Recommendations for maintenance publication improvements . . . . .	5
	II.	REPAIR PARTS FOR DS, GS, AND DEPOT MAINTENANCE . . . . .	6
	III.	INDEX - FEDERAL STOCK NUMBER AND REFERENCE IS NUMBER CROSS-REFERENCE TO FIGURE AND REFERENCE DESIGNATION . . . . .	27
	IV.	INDEX - REFERENCE DESIGNATION CROSS-REFERENCE TO PAGE NUMBER . . . . .	32

\* This manual supersedes Appendix A (DS, GS, and Depot Repair Parts) of TM 11-6625-821-45, 22 September 1966.



# SECTION I

## INTRODUCTION

### 1. Scope.

This manual lists repair parts and special tools required for the performance of direct support, general support, and depot level maintenance of the AN/ARM-93.

### 2. General.

This Repair Parts and Special Tools List is divided into the following sections:

- a. Repair Parts - Section II. A list of repair parts authorized for the performance of maintenance at the direct support, general support, and depot level.
- b. Federal Stock Number and Reference Number Index - Section III. A list of Federal stock numbers in ascending numerical sequence followed by a list of reference numbers (Manufacture P/N) in ascending alpha-numeric sequence, cross-referenced to the illustration figure number and reference designation.
- c. Reference Designation Cross-Reference to Page Number Index - Section IV. A list of reference designation numbers in alpha-numeric sequence, cross-referenced to page number of the Repair Parts List.

### 3. Explanation of Columns.

The following provides an explanation of columns in the tabular lists in Section II.

a. Source, Maintenance and Recoverability Codes (SMR), Column 1.

(1) Source code indicates the selection status and source for the listed item. Source codes are:

<u>Code</u>	<u>Explanation</u>
<u>P</u>	- applies to repair parts that are stocked in or supplied from the GSA/DSA, or Army supply system, and authorized for use at indicated maintenance categories.
<u>M</u>	- applies to repair parts that are not procured or stocked, but are to be manufactured at indicated maintenance categories.
<u>A</u>	- applies to assemblies that are not procured or stocked as such, but are made up of two or more units, each of which carry individual stock numbers and descriptions, and are procured and stocked and can be assembled by units at indicated maintenance categories.
<u>X</u>	- applies to parts and assemblies that are not procured or stocked; the mortality of which normally is below that of the applicable end item; and the failure of which should result in retirement of the end item from the supply system.

- X1 - applies to repair parts which are not procured or stocked, the requirement for which will be supplied by the use of the next higher assembly or component.
- X2 - applies to repair parts which are not stocked. The indicated maintenance category requiring such repair parts will attempt to obtain them through cannibalization; if not obtainable through cannibalization, such repair parts will be requisitioned with supporting justification through normal supply channels.
- C - applies to repair parts authorized for local procurement. If not obtainable from local procurement, such repair parts will be requisitioned through normal supply channels with a supporting statement of nonavailability from local procurement.
- G - applies to major assemblies that are procured with PEMA funds for initial issue only to be used as exchange assemblies at DSU and GSU level. These assemblies will not be stocked above DSU and GSU level or returned to depot supply level.

(2) Maintenance code indicates the lowest category of maintenance authorized to install the listed item. The maintenance level code is:

<u>Code</u>	<u>Explanation</u>
<u>C</u>	- Crew or operator maintenance
<u>O</u>	- Organizational maintenance
<u>E</u>	- Direct Support maintenance
<u>H</u>	- General Support maintenance
<u>D</u>	- Depot maintenance

(3) Recoverability code indicates whether unserviceable items should be returned for recovery on salvage. Items not coded are expendable. Recoverability codes are:

<u>Code</u>	<u>Explanation</u>
<u>R</u>	- applies to repair parts and assemblies which are economically repairable at DSU and GSU activities, and normally are furnished by supply on an exchange basis.

- S** - repair parts and assemblies which are economically repairable at DSU and GSU activities, and normally are furnished by supply on an exchange basis. When items are determined by a DSU to be uneconomically repairable, they will be evacuated to a depot for evaluation and analysis before final disposition.
- T** - applies to high dollar value recoverable repair parts which are subject to special handling and are issued on an exchange basis. Such repair parts normally are repaired or overhauled at depot maintenance activities.
- V** - applies to repair parts specifically selected for salvage by reclamation units because of precious metal content, critical materials, high dollar value reusable casings or castings.

b. Federal Stock Number, Column 2. This column indicates the Federal stock number assigned to the item and will be used for requisitioning purposes.

c. Description, Column 3. This column indicates the Federal item name and any additional description of the item required. A part number or other reference number is followed by the applicable five-digit Federal supply code for manufacturer in parentheses. Each item is indented with a dot(s). i.e., An item indented "A" in the description column will be preceded with one dot; an item indented "B" will be preceded by two dots, etc.

d. Unit of Measure (U/M), Column 4. A 2 character alphabetic abbreviation indicating the amount or quantity of the item upon which the allowances are based, e.g. , ft, ea, pr, etc.

e. Quantity Incorporated in Unit, Column 3. This column indicates the quantity used per reference designation (Column 10b). A "V" appearing in this column in lieu of a quantity indicates that a definite quantity cannot be indicated (e. g., SHIMS, SPACERS, etc.).

f. 30-Day DS/GS Maintenance Allowances, Columns 6 and 7.

NOTE: Allowances in GS column are for GS maintenance only.

(1) Separate columns for Direct Support (DS) and General Support (GS) indicate the total range of repair parts authorized for use at the appropriate categories.

(2) The allowance columns are divided into three sub-columns. An asterisk in these columns opposite the first appearance of each item indicates the item is authorized on an "as required" basis. Repair parts stockage at the DS/GS levels will be based on demand and determined in accordance with AR711-16. Subsequent appearances of the same item will have the letters "REF" in the allowance columns.

g. 1-Year Allowances Per 100 Equipments/Contingency Planning Purposes, Column 8. This column indicates items required to support 100 equipments for one year. An asterisk opposite the first appearance of each item indicates the range of items required.

h. Depot Maintenance Allowances Per 100 Equipments, Column 9. This column indicates items authorized for depot maintenance of 100 equipments. An asterisk opposite the first appearance of each item indicates the range of items authorized on an "as required" basis. Subsequent appearance of the same item will have the letters "REF" in this column when shown as a supply item.

i. Illustration, Column 10. This column is divided as follows:

(1) Figure Number, Column 10a. Indicates the figure number of the illustration in which the item is shown.

(2) Item Number, Column 10b. Indicates the call-out number or reference designation used to reference the item in the illustration.

#### 4. Special Information.

a. Repair parts mortality is computed from failure rates derived from experience factors with the individual parts in a variety of equipments. Variations in the specific application and periods of use of electronics equipment, the fragility of electronic piece parts, plus intangible material and quality factors intrinsic to the manufacture of electronic parts, do not permit mortality to be based on hours of end item use. However, long periods of continuous use under adverse conditions are likely to increase repair parts mortality.

b. Parts which require manufacture or assembly at a category higher than that authorized for installation will indicate in the source column the higher category.

#### 5. How to Locate Repair Parts.

a. When Federal stock number or reference number is unknown:

(1) First. Using the table of contents, determine the functional group within which the repair part belongs. This is necessary since illustrations are prepared for functional groups and listings are divided into the same groups.

(2) Second. Find the illustration covering the functional group to which the repair part belongs.

(3) Third. Identify the repair part on the illustration and note the illustration figure and reference designation of the repair part.

(4) Fourth. Using the repair parts listing, find the functional group to which the repair part belongs and locate the illustration figure and reference designation noted on the illustration.

b. When Federal stock number or reference is known:

(1) First. Using the Index of Federal Stock Numbers and Reference Numbers, find the pertinent Federal stock number or reference number. This index is in ascending FSN sequence followed by a list of reference numbers in alpha-numeric sequence, cross-referenced to the illustration figure number and reference designation number.

(2) Second. Using the repair part listing, find the functional group of the repair part and the illustration figure number and reference designation referenced in the Index of Federal Stock Numbers and Reference Numbers.

c. When the reference designation is known:

(1) First. Locate the reference designation in the Index-Reference Designation Cross-Reference to Page Numbers.

(2) Second. Note the page number; then locate the item in the list by the page numbers.

## 6. Federal Supply Code.

This paragraph lists the Federal supply and the associated manufacturer's name.

Code	Manufacturer
01181	New England Oven and Furnace Co, 385 Boston Post Road Orange, Corm 06477
02660	Bunkerramo Corp, The Amphenol Connector Div. 2801 S. 25th Ave. Broadview, IL 60153
02735	Radio Corp. of America Solid State and Rec. Tube Div. Route 202 Somerville, NJ 08876
02768	Illinois Tool Works Inc. Fastex Division 195 Algonquin Road Des Plaines, IL 60016
03508	General Electric Co. Semiconductor Products Dept. Electronics Park Syracuse, NY 13201
03877	Transitron Electronic Corp. 168-186 Albion St. Wakefield, MA 01880
04009	Arrowhart Inc. 103 Hawthorne St. Hartford, Corm. 06106
04211	Coastal Dynamics Corp. 219 Rose Ave. Venice, CA 90291
05973	Haveg Super-Temperature Wires P.O. Box 7 Winooski, VT 05404
06481	Litton Systems Inc. Guidance and Control Systems Div. 5500 Canoga Ave. Woodland Hills, CA 91364
08289	Blinn Delbert Co., Inc., The P.O. Box 2007 Pomona, CA 91766
09922	Burndy Corp. Richards Ave. Norwalk, CT 06852
11402	Hisonic Inc. 249 N. Troost Olathe, KS 66061
12515	Teledyne Thermatics P.O. Drawer 505 Elm City, N.C. 27822
12615	U.S. Terminals, Inc. 7504 Camargo Rd. Cincinnati, OH 45243
13499	Collins Radio Company 5225 C Ave. N.E. Cedar Rapids, IA 52406
21537	Screw Craft Products 1912 N. Elston Ave. Chicago, IL 60607
24363	Executive Instruments Inc. P.O. Box 75 Addison, TX 75001
56289	Sprague Electric Co. Marshal St. North Adams, MA 01247
57771	Edwin B. Stimpson Co., Inc. 70 Franklin Ave. Brooklyn, NY 11205
58474	Superior Electric Co., The 383 Middle St. Bristol, CT 06010
70485	Atlantic India Rubber Works 571 W. Polk St. Chicago, IL 60607
70674	ADC Products Div. Of Magnetic Controls CO. 4900 West 78th St. Minneapolis, MN 55426
70903	Belden Corp. 415 S. Kilpatrick Chicago, IL 60644
71279	Cambridge Thermionic Corp. 445 Concord Ave. Cambridge, MA 02138

Code	Manufacturer	Code	Manufacturer
71286	Camloc Division Rex Chainbelt, Inc. 22 Spring Valley Road Paramus, N.J. 07652	75543	Lavelle Rubber Co. 424 N. Wood Chicago, IL 60622
71400	Bussman Mfg. Division of McGraw and Edison Co. 2536 W. University St. St. Louis, MO 63017	75818	Lenz Electric Mfg Co. 1757 N. Western Ave. Chicago, IL 60647
71450	CTS Corp. 1142 W. Beardsley Ave. Elkhart, IN 46514	76854	Oak Mfg. Co. Div. of Oak Electro/Netics Corp. S. Main Crystal Lake, IL 60014
71468	ITT Cannon Electric, Inc. 3208 Humbolt St. Los Angeles, CA 90031	77147	Patton MacGuyer Co. Div. of Avid Corp. 17 Virginia Ave. Providence, RI 02905
71744	Chicago Miniature Lamp Works 4433 Ravenswood Ave. Chicago, IL 60640	77250	Pheoll Mfg. Co. Div. of Allied Products Corp. 5700 W. Roosevelt Rd. Chicago, IL 60650
71785	Cinch Mfg. Co. & Howard B. Jones Div. 1026 S. Homan Ave. Chicago, IL 60624	77820	Bendix Corp. Electrical Components Div., The Sherman Ave. Sidney, NY 13838
72136	Electric Motive Mfg. Co., Inc., The South Park and John Streets Willimantic, CT 06226	78189	Illinois Tool Works, Inc. Shakeproof Division St. Charles Rd. Elgin, IL 60120
72512	Davies Harry Molding Co. 4920 W. Bloomingdales Ave. Chicago, IL 60639	79136	Waldes Kohinoor, Inc. 47-16 Austel Place Long Island City, NY 11101
72619	Dialight Corp. 60 Stewart Ave. Brooklyn, NY 11237	79807	Wrought Washer Mfg. Co. 2100 S. O Bay St. Milwaukee, WI 53207
72794	Dzus Fastener Co., Inc. 425 Union Blvd. West Islip, NY 11795	80058	Joint Electronics Type Designation System
72962	Elastic Stop Nut Division of Amerace Esna Corp. 2330 Vauxhall Road Union, NJ 07083	81030	International Instruments, Inc. 88 Marsh Hill Rd. Orange, CT 06477
73386	Freed Transformer Co., Inc. 1736 Weirfield St. Brooklyn, NY 11227	81073	Grayhill, Inc. 561 Hillgrove Ave. La Grange, IL 60525
74284	Skydyne Inc. River View Port Jervis, NY 12771	81349	Military Specifications Promulgated by Standardization Div. Directorate of Logistic Services DSA
74970	E. F. Johnson Co. 297 Tenth Ave., S.W. Waseca, MN 56093	81640	Control Switch Division Controls Co. of America Folcroft, PA 19032

Code	Manufacturer
82104	Standard Grigsby Co. 920 Rathbone Ave. Aurora, IL 60507
88818	Kearfott Division of General Precision, Inc. 1150 McBride Little Falls, NJ 07424
90484	ITT, Surprenant Div. Clinton, MA 01510
91314	Lewis Spring and Mfg. Co. 2652 W. North Ave. Chicago, IL 60647
91500	Asheville-Schoonmaker Mica Co. 910 Jefferson Ave. Newport News, VA 23607
91637	Dale Electronics, Inc. P.O. Box 609 Columbus, NB 68601
92607	Tensolite Division of Carlisle Corp. 198 Main St. Tarrytown, NY 10591
94130	Camden Wire Co., Inc. 12 Masonic Ave. Camden, NY 13316
95238	Continental Connector, Corp. 34 and 63 56th St. Woodside, NY 11377
96906	Military Standards Promulgated by Standardization Div. Directorate of Logistic Services DSA
98291	Sealectro Corp. 225 Hoyt Mamaroneck, NY 10544

## **7. Recommendations for Maintenance Publication Improvements**

Report of errors, omissions, and recommendations for improving this publication by the individual user is encouraged. Reports should be submitted on DA Form 2028 (Recommended Changes to DA Publication) and forwarded direct to Commander, U.S. Army Electronics Command, ATTN: AMSEL-MA-AN, Fort Monmouth, New Jersey, 07703.

SECTION II. REPAIR PARTS FOR DIRECT SUPPORT, GENERAL SUPPORT, AND DEPOT MAINTENANCE

(1) SMR CODE	(2) FEDERAL STOCK NUMBER	(3) DESCRIPTION REFERENCE NUMBER & MFR CODE	USABLE ON CODE	(4) UNIT OF MEAS	(5) QTY INC	(6) 30-DAY DS MAINT ALLOWANCE (A) (B) (C)	(7) 30-DAY GS MAINT ALLOWANCE (A) (B) (C)	(8) 1 YR ALW PER EQUIP COM- TGCY	(9) DEPOT MAINT ALW PER 100 EQUIP	(10) ILLUSTRATIONS (A) FIG NO (B) ITEM NO OR REFERENCE DESIGNATION
		TEST SET,RADIO AN/ARM-93								
A001	6625-999-5119	.TEST SET,AUTOMATIC DIRECTION FINDER,4770-3: ANARM93(80058)		EA	1					1 1
A--H-R A002	6625-935-2567	..CABLE ASSEMBLY,RADIO FREQUENCY INPUT: 762-1551-001(13499)		EA	1					2 W2
P--H-- A003	5935-835-0508	...CONNECTOR,PLUG,ELECTRICAL: M39012-16-0001(81349)		EA	1		*	*	*	2 W2P1
P--H-- A004	5935-835-0508	...CONNECTOR,PLUG,ELECTRICAL SAME AS A003		EA	1		REF	REF	REF	2 W2P2
A--H-R A005	6625-947-3413	...CABLE ASSEMBLY,SPECIAL PURPOSE,LOOP: 549-6545-004(13499)		EA	1					2 W3
P--H-- A006	5935-280-2195	...CLAMP,CABLE,ELECTRICAL CONNECTOR: 97-3057-6(02660)		EA	1		*	*	*	2 W3MP1
P--H-- A007	5325-275-4476	...EYELET,METALLIC: 496CDPL(01181)		EA	1		*	*	*	2 W3MP1H1
P--H-- A008	5935-280-2195	...CLAMP,CABLE,ELECTRICAL CONNECTOR: SAME AS A006		EA	1		*	*	*	2 W3MP2
P--H-- A009	5325-275-4476	...EYELET,METALLIC: SAME AS A007		EA	1		REF	REF	REF	2 W3MP2H1
P--H-- A010	5935-683-5281	...CONNECTOR,PLUG,ELECTRICAL: PT06A12-10S(77820)		EA	1		*	*	*	2 W3P1
P--H-- A011	5935-683-5281	...CONNECTOR,PLUG,ELECTRICAL: SAME AS A010		EA	1		REF	REF	REF	2 W3P2
A--H-R A012	6625-947-3414	...CABLE ASSEMBLY,INVERTER SERVICE: 762-1561-001(13499)		EA	1					2 W4
P--H-- A013	5935-937-2162	...CONNECTOR,PLUG,ELECTRICAL: 7030-5P1004(03877)		EA	1		*	*	*	2 W4P2
P--H-- A014	5935-959-6853	...CONNECTOR,RECEPTACLE, ELECTRICAL: MM5-22SGDSS(95238)		EA	1		*	*	*	2 W4P1
A--H-R A015		..CASE ASSEMBLY,BOTTOM: 762-1555-001(13499)		EA	1					1 MP3
M--D-- A016		...BRACKET,DIVIDER: 762-1564-002(13499)		EA	1					1 MP3MP1
P--H-- A017	5310-857-5547	...NUT,SELF-LOCKING,HEXAGON: 68NM62(72962)		EA	4		*	*	*	1 MP3MP1H1
P--H-- A018	5305-054-6653	...SCREW,MACHINE: MSS1957-29(96906)		EA	4		*	*	*	1 MP3MP1H2
P--H-- A019	5310-531-9514	...WASHER,FLAT: 2310-6360-000(79807)		EA	4		*	*	*	1 MP3MP1H3
M--D-- A020		...BRACKET,PANEL MOUNTING: 762-1553-003(13499)		EA	1					1 MP3MP2
P--H-- A021	5310-857-5547	...NUT,SELF-LOCKING,HEXAGON: SAME AS A017		EA	4		REF	REF	REF	1 MP3MP2H1
P--H-- A022	5305-054-6653	...SCREW,MACHINE: SAME AS A018		EA	4		REF	REF	REF	1 MP3MP2H2
P--H-- A023	5310-866-3506	...NUT,SELF-LOCKING,CLINCH: F12NCFMA2-62(72962)		EA	7		*	*	*	1 MP3MP2H3



SECTION II. REPAIR PARTS FOR DIRECT SUPPORT, GENERAL SUPPORT, AND DEPOT MAINTENANCE (CONTINUED)

SMR CODE	FEDERAL STOCK NUMBER	DESCRIPTION REFERENCE NUMBER & MFR CODE	USABLE ON CODE	(4) UNIT OF MEAS	(5) QTY INC IN UNIT	(6) 30-DAY DS MAINT ALLOWANCE			(7) 30-DAY GS MAINT ALLOWANCE			(8) 1 YR ALW PER EQUIP COM-TGCY	(9) DEPOT MAINT ALW PER 100 EQUIP	(10) ILLUSTRATIONS	
						(A)	(B)	(C)	(A)	(B)	(C)			(A)	(B)
						1-20	21-50	51-100	1-20	21-50	51-100			FIG NO	ITEM NO OR REFERENCE DESIGNATION
A--H-R A024		...CASE,BOTTOM SECTION: 021-0381-030(74284)		EA	1									1	MP3MP3
A--H-R A025		...COVER,STOWAGE: 762-1565-002(13499)		EA	1									1	MP3MP4
P--H-- A026	5310-857-5547	...NUT,SELF-LOCKING,HEXAGON: SAME AS A017		EA	3				REF	REF	REF	REF	REF	1	MP3MP4H1
P--H-- A027	5305-054-6653	...SCREW,MACHINE: SAME AS A018		EA	3				REF	REF	REF	REF	REF	1	MP3MP4H2
P--H-- A028	5310-337-8329	...PUSH ON NUT: 2600LM(712186)		EA	1				*	*	*	*	*	1	MP3MP4H3
P--H-- A029	5325-137-0039	...STUD ASSEMBLY,TURNLOCK: 26S1386(71286)		EA	1				*	*	*	*	*	1	MP3MP4H4
P--H-- A030	5325-171-4365	...RECEPTACLE,TURNLOCK FASTENER: 212-12N(71286)		EA	1				*	*	*	*	*	1	MP3MP5
P--H-- A031	5320-584-0672	...RIVET,SOLID: MS20426AD3-6(96906)		EA	2				*	*	*	*	*	1	MP3MP5H1
A--H-R A032	6625-933-3526	...CASE ASSEMBLY, TOP: 762-1495-001(13499)		EA	1									1	A1
A--H-R A033		...CASE, TOP SECTION: 021-0381-020(74284)		EA	1									1	A1MP4
M--D-- A034		...HOLDER, LOOP TEST FIXTURE: 762-1702-001(13499)		EA	1									1	A1MP5
A--H-R A035	6625-999-9101	...LOOP TEST FIXTURE: 762-1499-003(13499)		EA	1									1	A1A1
M--H-- A036		...BOARD MOUNTING: 762-1499-002(13499)		EA	1									4	A1A1MP6
P--H-- A037	5305-054-5647	...SCREW,MACHINE: MS51957-13(96906)		EA	6				*	*	*	*	*	3	A1A1MP6H1
P--H-- A038	5310-136-6133	...WASHER,FLAT: 310-6340-000(79807)		EA	6				*	*	*	*	*	3	A1A1MP6H2
P--H-- A039	5310-933-8118	...WASHER,LOCK: MS35338-135(96906)		EA	6				*	*	*	*	*	3	A1A1MPGH3
M--H-- A040		...BOX, FIXTURE: 762-1499-001(13499)		EA	1									4	A1A1MP7
P--H-- A041	5910-060-6266	...CAPACITOR, FIXED, MICA DIELECTRIC: CM06GD102F03(81349)		EA	1				*	*	*	*	*	4	A1A1C1
P--H-- A042	5935-683-5281	...CONNECTOR, PLUG, ELECTRICAL: SAME AS A010		EA	1				REF	REF	REF	REF	REF	4	A1A1P1
X1--H-- A043		...BUSHING: 762-1680-001(13499)		EA	1									4	A1A1P1H1
X1--H-- A044		...NUT, HEXAGON: 10-123017-10-3(77820)		EA	1									4	A1A1P1H2
P--O-- A045	5355-616-9604	...KNOB: MS91528-1P2B(96906)		EA	1	*	*	*	*	*	*	*	*	3	A1A1MP8
M--D-- A046		...NAMEPLATE: 762-1736-003(13499)		EA	1									3	A1A1MP9
P--H-- A047	5305-054-5635	...SCREW,MACHINE: MS51957-1		EA	2				*	*	*	*	*	3	A1A1MP9H1
P--H-- A048	5935-224-5984	...PLUG,TIP: 108-750-1(74970)		EA	1				*	*	*	*	*	3	A1A1P2

## SECTION II. REPAIR PARTS FOR DIRECT SUPPORT, GENERAL SUPPORT, AND DEPOT MAINTENANCE (CONTINUED)

SMR CODE	FEDERAL STOCK NUMBER	DESCRIPTION REFERENCE NUMBER & MFR CODE	USABLE ON CODE	(4) UNIT OF MEAS	(5) QTY INC IN UNIT	(6) 30-DAY DS MAINT ALLOWANCE			(7) 30-DAY GS MAINT ALLOWANCE			(8) 1 YR ALW PER EQUIP COM- TKCY	(9) DEPOT MAINT ALW PER 100 EQUIP	(10) ILLUSTRATIONS	
						(A)	(B)	(C)	(A)	(B)	(C)			(A)	(B)
						1-20	21-50	51-100	1-20	21-50	51-100			FIG NO	ITEM NO OR REFERENCE DESIGNATION
P--H-- A049	5310-616-8660	...NUT,PLAIN,HEXAGON: F313-0045-000(77250)		EA	1				*	*	*	*	*	4	A1A1P2H1
P--H-- A050	5310-209-6069	...WASHER,LOCK: 310-0077-000(79807)		EA	1				*	*	*	*	*	4	A1A1P2H2
P--H-- A051	5935-224-5984	...PLUG,TIP SAME AS A048		EA	1				REF	REF	REF	REF	REF	3	A1A1P3
P--H-- A052	5310-616-8660	...NUT,PLAIN,HEXAGON: SAME AS A049		EA	1				REF	REF	REF	REF	REF	4	A1A1P3H1
P--H-- A053	5310-209-6069	...WASHER,LOCK: SAME AS A050		EA	1				REF	REF	REF	REF	REF	4	A1A1P3H2
P--H-- A054	5935-224-5984	...PLUG,TIP: SAME AS A048		EA	1				REF	REF	REF	REF	REF	3	A1A1P4
P--H-- A055	5310-616-8660	...NUT,PLAIN,HEXAGON: SAME AS A049		EA	1				REF	REF	REF	REF	REF	4	A1A1P4H1
P--H-- A056	5310-209-6069	...WASHER,LOCK: SAME AS A050		EA	1				REF	REF	REF	REF	REF	4	A1A1P4H2
P--H-- A057	5935-224-5984	...PLUG,TIP: SAME AS A048		EA	1				REF	REF	REF	REF	REF	3	A1A1P5
P--H-- A058	5310-616-8660	...NUT,PLAIN,HEXAGON: SAME AS A049		EA	1				REF	REF	REF	REF	REF	4	A1A1P5H1
P--H-- A059	5310-209-6069	...WASHER,LOCK: SAME AS A050		EA	1				REF	REF	REF	REF	REF	4	A1A1P5H2
M--H-- A060		...SPACER: 762-1679-002(13499)		EA	2									3	A1A1MP10
P--H-- A061	5305-054-6670	...SCREW,MACHINE: MS51957-45(96906)		EA	2				*	*	*	*	*	3	A1A1MP10H1
P--H-- A062	5310-209-1074	...WASHER,FLAT: 310-0048-000(79807)		EA	2				*	*	*	*	*	3	A1A1MP10H2
P--H-- A063	5310-933-8119	...WASHER,LOCK: MS35338-137(96906)		EA	2				*	*	*	*	*	3	A1A1MP10H3
M--H-- A064		...SPACER: 762-1679-001(13499)		EA	4									3	A1A1MP11
P--H-- A065	5305-054-6668	...SCREW,MACHINE: MS51957-43(96906)		EA	4				*	*	*	*	*	3	A1A1MP11H1
P--H-- A066	5310-933-8119	...WASHER,LOCK: SAME AS A063		EA	4				REF	REF	REF	REF	REF	3	A1A1MP11H2
P--H-- A067	5930-079-6562	...SWITCH,ROTARY: 44A30-02-1-2N(81073)		EA	1				*	*	*	*	*	4	A1A1S1
M--D-- A068		...PLATE,IDENTIFICATION: 762-1736-001(13499)		EA	1									1	A1MP12
P--H-- A069	5320-817-0728	...RIVET,TUBULAR: MS16535-53(96906)		EA	2				*	*	*	*	*	1	A1MP12H1
M--D-- A070		...PLATE,IDENTIFICATION: 762-1738-001(13499)		EA	1									1	A1MP13
P--H-- A071	5320-817-0728	...RIVET,TUBULAR: SAME AS A069		EA	2				REF	REF	REF	REF	REF	1	A1MP13H1
A--H-R A072	6625-945-7937	...SIMULATOR,SENSE ANTENNA: 762-1667-001(13499)		EA	1									2	A2
M--D-- A073		...BOX,DRUM ALUMINUM: 762-1667-004(13499)		EA	1									5	A2MP14
P--H-- A074	5910-838-7126	...CAPACITOR,FIXED,MICA DIELECTRIC: DM15C050D500WV4CR(72136)		EA	1				*	*	*	*	*	5	A2C1 TEST SELECT

## SECTION II. REPAIR PARTS FOR DIRECT SUPPORT, GENERAL SUPPORT, AND DEPOT MAINTENANCE (CONTINUED)

SMR CODE	FEDERAL STOCK NUMBER	DESCRIPTION  REFERENCE NUMBER & MFR CODE	USABLE ON CODE	(4) UNIT OF MEAS	(5) QTY INC IN UNIT	(6) 30-DAY DS MAINT ALLOWANCE			(7) 30-DAY GS MAINT ALLOWANCE			(8) 1 YR ALW PER EQUIP COM- TQCY	(9) DEPOT MAINT ALW PER 100 EQUIP	(10) ILLUSTRATIONS	
						(A)	(B)	(C)	(A)	(B)	(C)			(A)	(B)
						1-20	21-50	51-100	1-20	21-50	51-100			FIG NO	ITEM NO OR REFERENCE DESIGNATION
P--H-- A075	5910-999-5669	...CAPACITOR, FIXED, MICA DIELECTRIC: DM15C100K500WV4CR (72136)		EA	1				*	*	*	*		5	A2C1 TEST SELECT
P--H-- A076	5910-838-4240	...CAPACITOR, FIXED, MICA DIELECTRIC: DM15C150K500WV4CR (72136)		EA	1				*	*	*	*		5	A2C1 TEST SELECT
P--H-- A077		...CAPACITOR, FIXED, MICA DIELECTRIC: CM05FD131J03 (81349)		EA	1				*	*	*	*		5	A2C2
P--H-- A078	5910-999-5669	...CAPACITOR, FIXED, MICA DIELECTRIC: SAVE AS A075		EA	1				REF	REF	REF	REF		5	A2C2 TEST SELECT
P--H-- A079	5910-838-4240	...CAPACITOR, FIXED, MICA DIELECTRIC: SAME AS A076		EA	1				REF	REF	REF	REF		5	A2C3 TEST SELECT
P--H-- A080	5910-954-5496	...CAPACITOR, FIXED, MICA DIELECTRIC: DM15E200K500WV4CR (72136)		EA	1				*	*	*	*		5	A2C3 TEST SELECT
P--H-- A081	5910-456-0797	...CAPACITOR, FIXED, MICA DIELECTRIC: CM05FD241J03 (81349)		EA	1				*	*	*	*		5	A2C4
P--H-- A082	5910-999-5669	...CAPACITOR, FIXED, MICA DIELECTRIC: SAME AS A075		EA	1				REF	REF	REF	REF		5	A2C5
P--H-- A083	5935-755-3506	...CONNECTOR, RECEPTACLE, ELECTRICAL: PT106A10-6S (77820)		EA	1				*	*	*	*		5	A2P1
XI--H-- A084	5310-815-1086	...NUT, PLAIN, HEXAGON: 334-0890-000 (21537)		EA	2									5	A2P1H1
P--H-- A085	5935-850-9157	...CONNECTOR, PLUG, ELECTRICAL: MS35170-260D (96906)		EA	1				*	*	*	*		2	A2P2
M--H-- A086		...COVER: 762-1667-003 (13499)		EA	1									25	A2MP15
P--H-- A087	5305-054-5652	...SCREW, MACHINE: MS51957-18 (96906)		EA	2				*	*	*	*		5	A2MP15H1
P--H-- A088	5310-933-8118	...WASHER, LOCK: SAME AS A039		EA	2				REF	REF	REF	REF		5	A2MP15H2
P--H-- A089	5325-263-6632	...GROMMET, RUBBER: MS35489-6 (96906)		EA	1				REF	REF	REF	REF		5	A2MP16
P--O-- A090	5355-878-9454	...KNOB, POINTER: 1400W (72512)		EA	1	*	*	*	*	*	*	*		5	A2MP1
M--D-- A091		...PLATE, IDENTIFICATION: 762-1736-002 (13499)		EA	1									25	A2MP18
P--H-- A092	5305-054-5635	...SCREW, MACHINE: SAME AS A047		EA	2				REF	REF	REF	REF		5	A2MP18H1
P--H-- A093	5310-754-3071	...POST, ELECTRICAL-MACHINICAL: 540-9053-003 (13499)		EA	2				*	*	*	*		5	A2MP19
P--H-- A094	5305-054-5652	...SCREW, MACHINE: SAME AS A087		EA	2				REF	REF	REF	REF		5	A2MP19H1
P--H-- A095	5310-933-8118	...WASHER, LOCK: SAME AS A039		EA	2				REF	REF	REF	REF		5	A2MP19H2
P--H-- A096	5930-963-5957	...SWITCH, ROTARY: 236924A1 (76854)		EA	1				REF	REF	REF	REF		5	A2S1
P--H-- A097	5310-208-4662	...NUT, PLAIN, HEXAGON: F313-0062-000 (77250)		EA	1				REF	REF	REF	REF		5	A2S1H1

SECTION II. REPAIR PARTS FOR DIRECT SUPPORT, GENERAL SUPPORT, AND DEPOT MAINTENANCE (CONTINUED)

(1)	(2)	(3)	(4)	(5)	(6)	(7)	(8)	(9)	(10)	
SMR CODE	FEDERAL STOCK NUMBER	DESCRIPTION REFERENCE NUMBER & MFR CODE	USABLE ON CODE	UNIT OF MEAS	QTY INC IN UNIT	30-DAY DS MAINT ALLOWANCE (A) (B) (C)	30-DAY GS MAINT ALLOWANCE (A) (B) (C)	1 YR ALW PER EQUIP COM-TGCY	DEPOT MAINT ALW PER 100 EQUIP	ILLUSTRATIONS (A) FIG NO (B) ITEM NO OR REFERENCE DESIGNATION
P--H-- A098	5310-595-7154	... WASHER, LOCK: 1720-02(78189)		EA	1		*	*	*	5 A2S1H2
P--H-- A099	5940-877-8430	... TERMINAL, STUD, ELECTRICAL: TF300(98291)		EA	1		*	*	*	5 A2E1
P--H-- A100	5305-054-5636	... SCREW, MACHINE: MS51957-2(96906)		EA	1		*	*	*	5 A2E1H1
P--H-- A101	5310-928-2690	... WASHER, LOCK, SPLIT: 310-0070-000(79807)		EA	1		*	*	*	5 A2E1H2
P--H-- A102	5940-702-3517	... TERMINAL, STUD-GROUND: AB396-1(12615)		EA	1		*	*	*	5 A2E2
P--H-- A103	5305-054-5636	... SCREW, MACHINE: SAME AS A100		EA	1		REF	REF	REF	5 A2E2H1
P--H-- A104	5310-928-2690	... WASHER, LOCK, SPLIT: SAME AS A101		EA	1		REF	REF	REF	5 A2E2H2
A--H-R A105	6625-999-6080	... TEST SET, RADIO: TS2502ARM93(80058)		EA	1					6 A3
P--H-- A106	5305-054-6651	... SCREW, MACHINE: MS51957-27(96906)		EA	7		*	*	*	6 A3H1
P--H-- A107	5310-515-8243	... WASHER, FLAT: 310-0046-000(79807)		EA	7		REF	REF	REF	6 A3H2
A--H-R A108		... BRACKET ASSEMBLY, INVERTER: 762-1560-003(13499)		EA	1					7 A3MP1
P--H-- A109	5310-208-3786	... NUT, PLAIN, HEXAGON: P313-0132-000(77250)		EA	4		*	*	*	7 A3MP1H1
P--H-- A110	5305-763-7822	... SCREW, MACHINE: MS51959-14(96906)		EA	4		*	*	*	7 A3MP1H2
P--H-- A111	5310-550-3715	... WASHER, LOCK: MS35333-70(96906)		EA	4		*	*	*	7 A3MP1H3
M--D-- A112		... BRACKET, INVERTER: 762-1560-002(13499)		EA	1					7 A3MP1MP1
P--H-- A113	5935-959-6853	... CONNECTOR, RECEPTACLE: SAME AS A014		EA	1		REF	REF	REF	7 A3MP1J6
A--H-R A114		... BRACKET ASSEMBLY: 762-1703-001(13499)		EA	1					7 A3A1
P--H-- A115	5310-208-3786	... NUT, PLAIN, HEXAGON: SAME AS A109		EA	4		REF	REF	REF	7 A3A1H1
P--H-- A116	5305-763-7822	... SCREW, MACHINE: SAME AS A110		EA	4		REF	REF	REF	7 A3A1H2
P--H-- A117	5310-550-3715	... WASHER, LOCK: SAME AS A111		EA	4		REF	REF	REF	7 A3A1H3
M--D-- A118		... BRACKET, MOUNTING: 762-1557-001(13499)		EA	1					7 A3A1MP2
P--H-- A119	5340-598-0383	... CLAMP, LOOP: HP4N(09922)		EA	2		*	*	*	7 A3A1MP3
P--H-- A120	5310-857-5547	... NUT, SELF-LOCKING, HEXAGON: SAME AS A017		EA	2		REF	REF	REF	7 A3A1MP3H1
P--H-- A121	5305-054-6654	... SCREW, MACHINE: MS51957-30(96906)		EA	2		*	*	*	7 A3A1MP3H2
P--H-- A122	5340-336-8164	... CLAMP, LOOP: HP10N(09922)		EA	1		*	*	*	7 A3A1MP4

SECTION II. REPAIR PARTS FOR DIRECT SUPPORT, GENERAL SUPPORT, AND DEPOT MAINTENANCE (CONTINUED)															
(1)	(2)	(3)	(4)	(5)	(6)			(7)			(8)	(9)	(10)		
SMR CODE	FEDERAL STOCK NUMBER	DESCRIPTION	USABLE ON CODE	UNIT OF MEAS	QTY INC IN UNIT	30-DAY DS MAINT ALLOWANCE			30-DAY GS MAINT ALLOWANCE			1 YR ALW PER EQUIP COM-TGCY	DEPOT MAINT ALW PER 100 EQUIP	ILLUSTRATIONS (A) FIG NO	(B) ITEM NO OR REFERENCE DESIGNATION
		REFERENCE NUMBER & MFR CODE				(A)	(B)	(C)	(A)	(B)	(C)				
P--H-- A123	5310-857-5547	...NUT, SELF-LOCKING, HEXAGON; SAME AS A017		EA	1				REF	REF	REF	REF	REF	7	A3A1MP4H1
P--H-- A124	5305-054-6654	...SCREW, MACHINE; SAME AS A121		EA	1				REF	REF	REF	REF	REF	7	A3A1MP4H2
P--H-- A125	5310-275-1347	...WASHER, FLAT; SAME AS A107		EA	1				REF	REF	REF	REF	REF	7	A3A1MP4H3
P--H-- A126	5950-959-3771	...COIL, TOROIDAL; MR3A11(11402)		EA	1	*	*	*	*	*	*	*	*	7	A3A1L11
P--H-- A127	5305-054-6651	...SCREW, MACHINE; SAME AS A106		EA	1				REF	REF	REF	REF	REF	7	A3A1L11H1
P--H-- A128	5310-616-3555	...WASHER, LOCK; MS35333-71(96906)		EA	1	*	*	*	*	*	*	*	*	7	A3A1L11H2
P--H-- A129	5935-149-3427	...CONNECTOR, RECEPTACLE; MS3102A145P(96906)		EA	1	*	*	*	*	*	*	*	*	7	A3A1J7
P--H-- A130	5310-208-3786	...NUT, PLAIN, HEXAGON; SAME AS A109		EA	4				REF	REF	REF	REF	REF	7	A3A1J7H1
P--H-- A131	5305-054-5649	...SCREW, MACHINE; MS51957-15(96906)		EA	4	*	*	*	*	*	*	*	*	7	A3A1J7H2
P--H-- A132	5310-550-3715	...WASHER, LOCK; SAME AS A111		EA	4				REF	REF	REF	REF	REF	7	A3A1J7H3
P--H-- A133	5325-174-5317	...GROMMET, RUBBER; MS35489-4(96906)		EA	1	*	*	*	*	*	*	*	*	7	A3A1MP5
P--H-- A134	5905-686-9997	...RESISTOR, FIXED, COMPOSITION; RCR07G682KS(81349)		EA	1	*	*	*	*	*	*	*	*	7	A3A1R6
P--H-- A135	5905-185-6966	...RESISTOR, FIXED, COMPOSITION; RCR20G271KS(81349)		EA	1	*	*	*	*	*	*	*	*	7	A3A1R7
P--H-- A136	5905-225-9389	...RESISTOR, FIXED, FILM; RM60D5113F(81349)		EA	1	*	*	*	*	*	*	*	*	7	A3A1R9
P--H-- A137	5905-549-3752	...RESISTOR, FIXED, WIREWOUND; RW29V161(81349)		EA	1	*	*	*	*	*	*	*	*	8	A3A1R10
P--H-- A138	5970-705-9527	...INSULATOR, ... WASHER; 302-0347-000(91500)		EA	1	*	*	*	*	*	*	*	*	8	A3A1R10H1
P--H-- A139	5970-284-7900	...INSULATOR, ... WASHER; 302-2300-000(16037)		EA	1	*	*	*	*	*	*	*	*	8	A3A1R10H2
P--H-- A140	5340-900-5823	...POST, MOUNTING, ... RESISTOR; P015-0558-000(77250)		EA	1	*	*	*	*	*	*	*	*	8	A3A1R10H3
P--H-- A141	5305-054-5647	...SCREW, MACHINE; SAME AS A037		EA	1				REF	REF	REF	REF	REF	8	A3A1R10H4
P--H-- A142	5305-054-5649	...SCREW, MACHINE; SAME AS A131		EA	1	*	*	*	*	*	*	*	*	8	A3A1R10H5
P--H-- A143	5310-725-5323	...WASHER, FLAT; 504-0730-003(13499)		EA	1	*	*	*	*	*	*	*	*	8	A3A1R10H6
P--H-- A144	5310-550-3715	...WASHER, LOCK; SAME AS A111		EA	1				REF	REF	REF	REF	REF	8	A3A1R10H7
P--H-- A145	5905-917-7045	...RESISTOR, VARIABLE, WIREWOUND; RA24705(71450)		EA	1	*	*	*	*	*	*	*	*	8	A3A1R8
P--H-- A146	5310-208-4662	...NUT, PLAIN, HEXAGON; SAME AS A097		EA	1				REF	REF	REF	REF	REF	8	A3A1R8H1
P--H-- A147	5310-595-7154	...WASHER, LOCK; SAME AS A098		EA	1				REF	REF	REF	REF	REF	8	A3A1R8H2

SECTION II. REPAIR PARTS FOR DIRECT SUPPORT, GENERAL SUPPORT, AND DEPOT MAINTENANCE (CONTINUED)

SMR CODE	FEDERAL STOCK NUMBER	DESCRIPTION REFERENCE NUMBER & MFR CODE	USABLE ON CODE	(4) UNIT OF MEAS	(5) QTY INC IN UNIT	(6) 30-DAY DS MAINT ALLOWANCE			(7) 30-DAY GS MAINT ALLOWANCE			(8) 1 YR ALW PER EQUIP COM-TCKY	(9) DEPOT MAINT ALW PER 100 EQUIP	(10) ILLUSTRATIONS	
						(A)	(B)	(C)	(A)	(B)	(C)			(A)	(B)
						1-20	21-50	51-100	1-20	21-50	51-100			FIG NO	ITEM NO OR REFERENCE DESIGNATION
P--H-- A148	5940-549-9610	... TERMINAL BOARD: 1181(06481)		EA	1				*	*	*	*	*	7	A3A1TB3
P--H-- A149	5305-680-6757	... SCREW MACHINE: P343-0386-000(77250)		EA	2				*	*	*	*	*	7	A3A1TB3H1
P--H-- A150	5310-676-8573	... WASHER, LOCK: 1203-00(78189)		EA	2				*	*	*	*	*	7	A3A1TB3H2
P--H-- A151	5940-847-3138	... TERMINAL, LUG: 2104-01-01-2520N(78189)		EA	1				*	*	*	*	*	8	A3A1E1
P--H-- A152	5961-057-6014	... TRANSISTOR: 4JX11B2023(03508)		EA	1				*	*	*	*	*	7	A3A1Q1
M--H-- A153		... CABLE ASSEMBLY CONTROL: 762-1710-001(13499)		EA	1									6	A3W2
P--H-- A154	5935-866-2255	... CONNECTOR, PLUG, ELECTRICAL: PT06A20-41SSR(77820)		EA	1				*	*	*	*	*	6	A3W2P1
A--H-R A155	6625-908-9578	... CABLE ASSEMBLY, POWER: 762-1496-001(13499)		EA	1									2	A3W1
P--H-- A156	5935-280-2195	... CLAMP, CABLE, ELECTRICAL CONNECTOR: SAME AS A006		EA	1				REF	REF	REF	REF	REF	2	A3W1WP1
P--H-- A157	5935-196-2234	... CONNECTOR, PLUG, ELECTRICAL: MS3106A14SS5		EA	1				*	*	*	*	*	2	A3W1P1
M--H-- A158		... CABLE ASSEMBLY-RECEIVER: 762-1498-001(13499)		EA	1									1	A3W3
P--H-- A159	5935-836-0499	... ADAPTER, CABLE TO CONNECTOR: DPX22017(71468)		EA	1				*	*	*	*	*	1	A3W3MP1
P--H-- A160	5935-325-0989	... CONNECTOR, RECEPTACLE: DPX45-335(71468)		EA	1				*	*	*	*	*	1	A3W3P2
P--H-- A161	5305-054-5647	... SCREW MACHINE: SAME AS A037		EA	4				REF	REF	REF	REF	REF	1	A3W3P2H1
P--H-- A162	5310-550-3715	... WASHER, LOCK: SAME AS A111		EA	4				REF	REF	REF	REF	REF	1	A3W3P2H2
M--D-- A163		... CAN, SHIELD-MODIFIED: 762-1709-001(13499)		EA	1									7	A3MP6
P--H-- A164	5910-246-8602	... CAPACITOR, FIXED, ELECTROLYTIC: CL33BL020MNE(81349)		EA	1				*	*	*	*	*	8	A3C6
P--H-- A165	5910-728-4093	... CAPACITOR, FIXED, MICA DIELECTRIC: CM06FD182G03(81349)		EA	1				*	*	*	*	*	9	A3C1
P--H-- A166	5935-843-2844	... CONNECTOR, JACK, BULKHEAD: UG910BU(80058)		EA	1				*	*	*	*	*	6	A3J10
P--H-- A167	5310-982-6580	... WASHER, FLAT, ROUND: MS27183-1(96906)		EA	2				*	*	*	*	*	6	A3J10H1
P--H-- A168	5935-196-2234	... CONNECTOR, PLUG, ELECTRICAL: SAME AS A157		EA	1				REF	REF	REF	REF	REF	7	A3P3
P--H-- A169	5935-280-2195	... ADAPTER, CABLE TO CONNECTOR: MS3057-6A(96906)		EA	1				*	*	*	*	*	7	A3P3MP1
P--H-- A170	5935-853-7596	... CONNECTOR, RECEPTACLE: UG1094U(80058)		EA	1				*	*	*	*	*	6	A3J8
A--H-R A171		... COVER ASSEMBLY, INVERTER: 762-1567-002(13499)		EA	1									6	A3MP7

SECTION II. REPAIR PARTS FOR DIRECT SUPPORT, GENERAL SUPPORT, AND DEPOT MAINTENANCE (CONTINUED)																
(1)	(2)	(3)	(4)	(5)	(6)			(7)			(8)	(9)	(10)			
SMR CODE	FEDERAL STOCK NUMBER	DESCRIPTION	USABLE ON CODE	UNIT OF MEAS	QTY INC IN UNIT	30-DAY DS MAINT ALLOWANCE			30-DAY GS MAINT ALLOWANCE			1 YR ALW PER EQUIP COM-TCKCY	DEPOT MAINT ALW PER 100 EQUIP	ILLUSTRATIONS (A) FIG NO	(B) ITEM NO OR REFERENCE DESIGNATION	
		REFERENCE NUMBER & MFR CODE				(A)	(B)	(C)	(A)	(B)	(C)					
P--H-- A172	5315-221-0465	...PIN,FASTENER: 98-2CP(78189)		EA	2				*	*	*	*	*		6	A3MP7H1
P--H-- A173	5325-059-4584	...STUD,TURNLOCK FASTENER: 9722-18-00-0243(02768)		EA	2				*	*	*	*	*		6	A3MP7H2
P--H-- A174		...WASHER,NYLON: 762-1775-001(13499)		EA	2				*	*	*	*	*		6	A3MP7H3
P--O-- A175	5920-877-9934	...FUSE,CARTRIDGE: F01A250V3AS(81349)		EA	1	*	*	*	*	*	*	*	*		6	A3P1
P--O-- A176	5920-280-4465	...FUSE,CARTRIDGE: F02A250V1AS(81349)		EA	1	*	*	*	*	*	*	*	*		6	A3P2
P--O-- A177	5920-877-9934	...FUSE,CARTRIDGE: SAME AS A175		EA	1	*	*	*	*	*	*	*	*		6	A3P3
P--O-- A178	5920-280-4465	...FUSE,CARTRIDGE: SAME AS A176		EA	1	REF	REF	REF	REF	REF	REF	REF	REF		6	A3P4
P--H-- A179	5920-892-9311	...FUSEHOLDER: HKPH(71400)		EA	1				*	*	*	*	*		6	A3XF1
P--H-- A180	5920-892-9311	...FUSEHOLDER: SAME AS A179		EA	1				REF	REF	REF	REF	REF		6	A3XF2
P--H-- A181	5920-892-9311	...FUSEHOLDER: SAME AS A179		EA	1				REF	REF	REF	REF	REF		6	A3XF3
P--H-- A182	5920-892-9311	...FUSEHOLDER: SAME AS A179		EA	1				REF	REF	REF	REF	REF		6	A3XF4
P--H-- A183	5325-174-5317	...GROMMET,RUBBER: SAME AS A133		EA	1				REF	REF	REF	REF	REF		9	A3MPS
P--H-- A184	5325-276-4993	...GROMMET,RUBBER: 905(75343)		EA	1				*	*	*	*	*		9	A3MP9
P--H-- A185	5935-415-6070	...JACK,TELEPHONE: 4-03649-0210(70674)		EA	1				*	*	*	*	*		8	A3J5
P--H-- A186	5310-208-4662	...NUT,PLAIN,HEXAGON: SAME AS A097		EA	1				REF	REF	REF	REF	REF		8	A3J5H1
P--H-- A187	5310-595-7154	...WASHER,LOCK: SAME AS A098		EA	1				REF	REF	REF	REF	REF		8	A3J5H2
P--O-- A188	5355-579-1210	...KNOB,CONTROL,PLASTIC: MS91528-3F2B(96906)		EA	1	*	*	*	*	*	*	*	*		6	A3MP10
P--O-- A189	5355-579-1210	...KNOB,CONTROL,PLASTIC: SAME AS A188		EA	1	REF	REF	REF	REF	REF	REF	REF	REF		6	A3MP11
P--O-- A190	6240-155-7836	...LAMP,INCANDESCENT: MS25237-327(96906)		EA	1	*	*	*	*	*	*	*	*		6	A3DS1
P--O-- A191	6240-155-7836	...LAMP,INCANDESCENT: SAME AS A190		EA	1	REF	REF	REF	REF	REF	REF	REF	REF		6	A3DS2
P--H-- A192	6210-813-8265	...LIGHT,INDICATOR-HOLDER: 162-8430-09-502(72619)		EA	1				*	*	*	*	*		6	A3XDS1
P--H-- A193	6210-813-8265	...LIGHT,INDICATOR-HOLDER: SAME AS A192		EA	1				REF	REF	REF	REF	REF		6	A3XDS2
P--H-- A194	6210-990-4637	...LIGHT,INDICATOR-LENS: 162-0931(72619)		EA	1				*	*	*	*	*		6	A3E1
P--H-- A195	6210-990-4637	...LIGHT,INDICATOR-LENS: SAME AS A194		EA	1				REF	REF	REF	REF	REF		6	A3E2
M--D-- A196		...PANEL,FRONT: 762-1563-002(13499)		EA	1										6	A3MP12
M--D-- A197		...PLATE,IDENTIFICATION: 762-1737-001(13499)		EA	1										6	A3MP13

SECTION II. REPAIR PARTS FOR DIRECT SUPPORT, GENERAL SUPPORT, AND DEPOT MAINTENANCE (CONTINUED)															
(1)	(2)	(3)	(4)	(5)	(6)			(7)			(8)	(9)	(10)		
SMR CODE	FEDERAL STOCK NUMBER	DESCRIPTION REFERENCE NUMBER & MFR CODE	USABLE ON CODE	UNIT OF MEAS	QTY INC IN UNIT	30-DAY DS MAINT ALLOWANCE			30-DAY GS MAINT ALLOWANCE			1 YR ALW PER EQUIP COM-TGCY	DEPOT MAINT ALW PER 100 EQUIP	ILLUSTRATIONS (A) FIG NO	(B) ITEM NO OR REFERENCE DESIGNATION
						(A)	(B)	(C)	(A)	(B)	(C)				
P--H-- A198	5305-054-5635	...SCREW,MACHINE: SAME AS A047		EA	2				REF	REF	REF	REF	REF	6	A3MP13H1
P--H-- A199	5940-356-2493	...POST,BINDING-PLUG JACK: DF30RC(58474)		EA	1				*	*	*	*	*	6	A3J1
P--H-- A200	5940-269-2219	...POST,BINDING-PLUG JACK: DF30BC(58474)		EA	1				*	*	*	*	*	6	A3J2
P--H-- A201	5940-356-2493	...POST,BINDING-PLUG JACK: SAME AS A199		EA	1				REF	REF	REF	REF	REF	6	A3J3
P--H-- A202	5940-269-2219	...POST,BINDING-PLUG JACK: SAME AS A200		EA	1				REF	REF	REF	REF	REF	6	A3J4
P--H-- A203	5340-705-3136	...POST,SPACING: 540-9221-003(13499)		EA	2				*	*	*	*	*	9	A3MP14
P--H-- A204	5305-054-6651	...SCREW,MACHINE: SAME AS A106		EA	4				REF	REF	REF	REF	REF	9	A3MP14H1
P--H-- A205	5310-616-3555	...WASHER, LOCK: SAME AS A128		EA	2				REF	REF	REF	REF	REF	9	A3MP14H2
P--H-- A206		...RECEPTACLE, STRIP: 762-1556-001(13499)		EA	1				*	*	*	*	*	7	A3MP15
P--H-- A207	5310-208-3786	...NUT,PLAIN,HEXAGON: SAME AS A109		EA	02				REF	REF	REF	REF	REF	7	A3MP15H1
P--H-- A208	5305-770-2579	...SCREW,MACHINE: MS1959-15(96906)		EA	2				*	*	*	*	*	7	A3MP15H2
P--H-- A209	5310-550-3715	...WASHER, LOCK: SAME AS A111		EA	2				REF	REF	REF	REF	REF	7	A3MP15H3
P--H-- A210		...RECEPTACLE, STRIP: SAME AS A206		EA	1				REF	REF	REF	REF	REF	7	A3MP16
P--H-- A211	5310-208-3786	...NUT,PLAIN,HEXAGON: SAME AS A109		EA	2				REF	REF	REF	REF	REF	7	A3MP16H1
P--H-- A212	5305-770-2579	...SCREW,MACHINE: SAME AS A208		EA	2				REF	REF	REF	REF	REF	7	A3MP16H2
P--H-- A213	5310-550-3715	...WASHER, LOCK: SAME AS A111		EA	2				REF	REF	REF	REF	REF	7	A3MP16H3
P--H-- A214	5905-913-5011	...RESISTOR, FIXED, FILM: RL32S10J(81349)		EA	1				*	*	*	*	*	9	A3R1
P--H-- A215	5905-989-5545	...RESISTOR, FIXED, FILM: RN65D9090F(81349)		EA	1				*	*	*	*	*	9	A3R2
P--H-- A216	5905-988-2317	...RESISTOR, FIXED, FILM: RN60D1001F(81349)		EA	1				*	*	*	*	*	9	A3R3
P--H-- A217	5905-952-6025	...RESISTOR, FIXED, FILM: RN60D4221F(81349)		EA	1				*	*	*	*	*	9	A3R4
P--H-- A218	5905-952-6025	...RESISTOR, FIXED, FILM: SAME AS A217		EA	1				REF	REF	REF	REF	REF	9	A3R5
P--H-- A219	5930-963-5956	...SWITCH, ROTARY: 259-2312-220(81349)		EA	1				*	*	*	*	*	7	A3S3
P--H-- A220	5930-966-1651	...SWITCH, ROTARY: 28235-728LR4(82104)		EA	1				*	*	*	*	*	7	A3S4
P--H-- A221	5310-208-4662	...NUT,PLAIN,HEXAGON: SAME AS A097		EA	1				REF	REF	REF	REF	REF	7	A3S4H1
P--H-- A222	5310-595-7154	...WASHER, LOCK: SAME AS A098		EA	1				REF	REF	REF	REF	REF	7	A3S4H2
P--H-- A223	5930-655-1514	...SWITCH, TOGGLE: 82980S(04009)		EA	1				*	*	*	*	*	6	A3S1



## SECTION II. REPAIR PARTS FOR DIRECT SUPPORT, GENERAL SUPPORT, AND DEPOT MAINTENANCE (CONTINUED)

SMR CODE	FEDERAL STOCK NUMBER	DESCRIPTION  REFERENCE NUMBER & MFR CODE	USABLE ON CODE	(4) UNIT OF MEAS	(5) QTY INC IN UNIT	(6) 30-DAY DS MAINT ALLOWANCE			(7) 30-DAY GS MAINT ALLOWANCE			(8) 1 YR ALW PER EQUIP COM- TGCV	(9) DEPOT MAINT ALW PER 100 EQUIP	(10) ILLUSTRATIONS	
						(A)	(B)	(C)	(A)	(B)	(C)			(A)	(B)
						1-20	21-50	51-100	1-20	21-50	51-100			FIG NO	ITEM NO OR REFERENCE DESIGNATION
P--H-- A224	5930-655-1514	...SWITCH, TOGGLE: SAME AS A223		EA	1				REF	REF	REF	REF	REF	6	A3S2
P--H-- A225	5940-842-2917	...TERMINAL BOARD: 1542A(71785)		EA	1				*	*	*	*	*	9	A3TB1
P--H-- A226	5940-842-2917	...TERMINAL BOARD: SAME AS A225		EA	1				REF	REF	REF	REF	REF	9	A3TB2
P--H-- A227	5940-842-2917	...TERMINAL BOARD: SAME AS A225		EA	1				REF	REF	REF	REF	REF	9	A3TB4
P--H-- A228	5940-847-3138	...TERMINAL, LUG: SAME AS A151		EA	1				REF	REF	REF	REF	REF	7	A3E3
P--H-- A229	6625-903-4361	...INDICATOR, BEARING: 200101(24363)		EA	1				*	*	*	*	*	6	A3DS3
P--H-- A230	5310-616-8660	...NUT, FLAIN, HEXAGON: SAME AS A049		EA	4				REF	REF	REF	REF	REF	6	A3DS3H1
P--H-- A231	5305-059-8255	SCREW, MACHINE: MS35214-30(96906)		EA	4				*	*	*	*	*	6	A3DS3H2
P--H-- A232	5310-616-3555	...WASHER, LOCK: SAME AS A128		EA	4				REF	REF	REF	REF	REF	6	A3DS3H3
X1-H-- A233		...CONNECTOR, PLUG, ELECTRICAL: 100105(24363)		EA	1									10	A3DS3J1
X1-H-- A234		...GASKET, CONNECTOR: 1001006(24363)		EA	1									10	A3DS3J1MP14
X1-H-- A235		...WASHER, LOCK: 210104-4(24363)		EA	4									10	A3DS3J1H13
X1-H-- A236		...SCREW, MACHINE: 110104-4(24363)		EA	4									10	A3DS3J1H12
X1-H-- A237		...COVER, FRONT: 100131(24363)		EA	1									10	A3DS3MP11
X1-H-- A238		...DIAL: 100118(24363)		EA	1									10	A3DS3MP6
X1-H-- A239		...GASKET, CASE: 100129(24363)		EA	1									10	A3DS3MP19
X1-H-- A240		...GLASS: 100123(24363)		EA	1									10	A3DS3MP9
X1-H-- A241		...HOUSING, REAR: 100102-2(24363)		EA	1									10	A3DS3MP15
X1-H-- A242		...WASHER, LOCK: 210102-2(24363)		EA	8									10	A3DS3MP15H18
X1-H-- A243		...SCREW, MACHINE: 110102-2(24363)		EA	8									10	A3DS3MP15H17
X1-H-- A244		...HOUSING, SYNCHRO: 100103-1(24363)		EA	1									10	A3DS3MP5
X1-H-- A245		...NAMEPLATE: 100120-2(24363)		EA	1									10	A3DS3MP16
X1-H-- A246		...POINTER: 100126(24363)		EA	1									10	A3DS3MP7
X1-H-- A247		...RETAINER, DIAL: 10124(24363)		EA	1									10	A3DS3MP8
X1-H-- A248		...SEAL, WINDOW: 100116(24363)		EA	1									10	A3DS3MP10
X1-H-- A249		...SYNCHRO: 200121(24363)		EA	1									10	A3DS3MP1

## SECTION II. REPAIR PARTS FOR DIRECT SUPPORT, GENERAL SUPPORT, AND DEPOT MAINTENANCE (CONTINUED)

SMR CODE	FEDERAL STOCK NUMBER	DESCRIPTION REFERENCE NUMBER & MFR CODE	USABLE ON CODE	(4) UNIT OF MEAS	(5) QTY INC IN UNIT	(6) 30-DAY DS MAINT ALLOWANCE			(7) 30-DAY GS MAINT ALLOWANCE			(8) 1 YR ALW PER EQUIP COM- TGCY	(9) DEPOT MAINT ALW PER 100 EQUIP	(10) ILLUSTRATIONS	
						(A)	(B)	(C)	(A)	(B)	(C)			(A)	(B)
						1-20	21-50	51-100	1-20	21-50	51-100			FIG NO	ITEM NO OR REFERENCE DESIGNATION
X1-H-- A250		...CLAMP, SYNCHRO: 100122(24363)		EA	3									10	A3DS3MP1MP4
X1-H-- A251		...WASHER, LOCK: SAME AS A235		EA	3									10	A3DS3MP1H3
X1-H-- A252		...SCREW, MACHINE: SAME AS A236		EA	3									10	SA3DS3MP1H2
A--H-S A253	6125-945-0100	...INVERTER, AUTOMATIC DIRECTION FINDER: CV2128ARN83(80058)		EA	1									6	A3A2
P--H-- A254	5910-542-7387	...CAPACITOR, FIXED, ELECTROLYTIC: 150D475X0035B2(56289)		EA	1				*	*	*	*	*	11	A3A2C1
P--H-- A255	5910-812-0948	...CAPACITOR, FIXED, ELECTROLYTIC: 150D345X0915A2(56289)		EA	1				*	*	*	*	*	11	A3A2C2
P--H-- A256	5910-542-7387	...CAPACITOR, FIXED, ELECTROLYTIC: SAME AS A254		EA	1				REF	REF	REF	REF	REF	11	A3A2C3
P--H-- A257	5910-542-7387	...CAPACITOR, FIXED, ELECTROLYTIC: SAME AS A254		EA	1				REF	REF	REF	REF	REF	11	A3A2C4
P--H-- A258	5910-111-8593	...CAPACITOR, FIXED, ELECTROLYTIC: CL33B1100MNE(81349)		EA	1				*	*	*	*	*	11	A3A2C5
P--H-- A259	5910-542-7372	...CAPACITOR, FIXED, ELECTROLYTIC: 150D106X0020B2(56289)		EA	1				*	*	*	*	*	11	A3A2C6 TEST SELECT
P--H-- A260	5910-542-7371	...CAPACITOR, FIXED, ELECTROLYTIC: 150D225X0020A2(56289)		EA	1				*	*	*	*	*	11	A3A2C6 TEST SELECT
P--H-- A261	5910-542-7387	...CAPACITOR, FIXED, ELECTROLYTIC: SAME AS A254		EA	1				REF	REF	REF	REF	REF	11	A3A2C6 TEST SELECT
P--H-- A262	5910-934-2922	...CAPACITOR, FIXED, ELECTROLYTIC: 150D395X9035B2(56289)		EA	1				*	*	*	*	*	11	A3A2C6 TEST SELECT
P--H-- A263	5910-814-5869	...CAPACITOR, FIXED, ELECTROLYTIC: 150D685X0035B2(56289)		EA	1				*	*	*	*	*	11	A3A2C6 TEST SELECT
P--H-- A264	5910-812-0948	...CAPACITOR, FIXED, ELECTROLYTIC: SAME AS A255		EA	1				REF	REF	REF	REF	REF	11	A3A2C6 TEST SELECT
P--H-- A265	5910-726-5003	...CAPACITOR, FIXED, ELECTROLYTIC: 150D105X0035A2(56289)		EA	1				*	*	*	*	*	12	A3A2C8
P--H-- A266	5910-726-5003	...CAPACITOR, FIXED, ELECTROLYTIC: SAME AS A265		EA	1				REF	REF	REF	REF	REF	12	A3A2C9
M--D-- A267		...CHASSIS, ELECTRICAL EQUIPMENT, DECK: 767-8168-001(13499)		EA	1									12	A3A2A1
P--H-- A268	5310-050-6833	...NUT, SELF-LOCKING, CLINCH: R22NCFM1-40(72962)		EA	3				*	*	*	*	*	12	A3A2A1H1
P--H-- A269	5305-054-5646	...SCREW, MACHINE: MS51957-12(96906)		EA	1				*	*	*	*	*	12	A3A2A1H2
P--H-- A270	5305-054-5647	...SCREW, MACHINE: SAME AS A037		EA	2				REF	REF	REF	REF	REF	12	A3A2A1H3

SECTION II. REPAIR PARTS FOR DIRECT SUPPORT, GENERAL SUPPORT, AND DEPOT MAINTENANCE (CONTINUED)																
(1)	(2)	(3)	(4)	(5)	(6)	(7)			(8)	(9)	(10)					
SMR CODE	FEDERAL STOCK NUMBER	DESCRIPTION	USABLE ON CODE	UNIT OF MEAS	QTY INC IN UNIT	30-DAY DS MAINT ALLOWANCE			30-DAY GS MAINT ALLOWANCE			1 YR ALW PER EQUIP COM-TGCY	DEPOT MAINT ALW PER 100 EQUIP	ILLUSTRATIONS (A) FIG NO	(B) ITEM NO OR REFERENCE DESIGNATION	
		REFERENCE NUMBER & MFR CODE				(A)	(B)	(C)	(A)	(B)	(C)					
M--D-- A271		...CHASSIS, ELECTRICAL EQUIPMENT, FRAME: 763-6272-001(13499)		EA	1										12	A3A2A2
P--H-- A272		...BUSHING, CAPTIVE SCREW: 768-1151-001(13499)		EA	2				*	*	*	*	*		12	A3A2A2H1
P--H-- A273	5305-054-5650	...SCREW, MACHINE: MS51957-16(96906)		EA	2				*	*	*	*	*		12	A3A2A2H2
P--H-- A274	5365-717-8566	...SLEEVE, SPRING: 340-0644-000(91314)		EA	2				*	*	*	*	*		12	A3A2A2H3
P--H-- A275	5310-933-8118	...WASHER, LOCK: SAME AS A039		EA	2				REF	REF	REF	REF	REF		12	A3A2A2H4
P--H-- A276	5935-937-2162	...CONNECTOR, PLUG, ELECTRICAL: SAME AS A013		EA	1				REF	REF	REF	REF	REF		11	A3A2J1
P--H-- A277	5950-945-3866	...REACTOR: A16634(70674)		EA	1				*	*	*	*	*		12	A3A2L1
P--H-- A278	5310-208-3786	...NUT, PLAIN, HEXAGON: SAME AS A109		EA	2				REF	REF	REF	REF	REF		12	A3A2L1H1
P--H-- A279	5305-770-2533	...SCREW, MACHINE: P330-2290-000(77250)		EA	2				*	*	*	*	*		12	A3A2L1H2
P--H-- A280	5310-933-8118	...WASHER, LOCK: SAME AS A039		EA	2				REF	REF	REF	REF	REF		12	A3A2L1H3
P--H-- A281	5905-070-9383	...RESISTOR, FIXED, COMPOSITION: RCR07G331KS(81349)		EA	1				*	*	*	*	*		12	A3A2R2
P--H-- A282	5905-252-4018	...RESISTOR, FIXED, COMPOSITION: RCR20G470KS(81349)		EA	1				*	*	*	*	*		12	A3A2R3
P--H-- A283	5905-755-0796	...RESISTOR, FIXED, COMPOSITION: RCR07G821KS(81349)		EA	1				*	*	*	*	*		12	A3A2R4
P--H-- A284	5905-755-0796	...RESISTOR, FIXED, COMPOSITION: SAME AS A283		EA	1				REF	REF	REF	REF	REF		12	A3A2R5
P--H-- A285	5905-279-2672	...RESISTOR, FIXED, COMPOSITION: RCR20G182KS(81349)		EA	1				*	*	*	*	*		12	A3A2R6
P--H-- A286	5905-899-9239	...RESISTOR, VARIABLE: 380-1583-000(01121)		EA	1				*	*	*	*	*		11	A3A2R1
P--H-- A287	5310-924-8526	...NUT, PLAIN, HEXAGON: P334-0287-000(77250)		EA	1				*	*	*	*	*		11	A3A2R1H1
P--H-- A288	5310-811-0494	...WASHER, LOCK: 1714-05(78189)		EA	1				*	*	*	*	*		11	A3A2R1H2
P--H-- A289		...TERMINAL, FEEDTHRU, INSULATED: SL388-351RMT(12615)		EA	1				*	*	*	*	*		12	A3A2E1
P--H-- A290		...TERMINAL, FEEDTHRU, INSULATED: SAME AS A289		EA	1				REF	REF	REF	REF	REF		12	A3A2E2
P--H-- A291		...TERMINAL, FEEDTHRU, INSULATED: SAME AS A289		EA	1				REF	REF	REF	REF	REF		12	A3A2E3
P--H-- A292		...TERMINAL, FEEDTHRU, INSULATED: SAME AS A289		EA	1				REF	REF	REF	REF	REF		12	A3A2E4
P--H-- A293		...TERMINAL, FEEDTHRU, INSULATED: SAME AS A289		EA	1				REF	REF	REF	REF	REF		12	A3A2E5

## SECTION II. REPAIR PARTS FOR DIRECT SUPPORT, GENERAL SUPPORT, AND DEPOT MAINTENANCE (CONTINUED)

SMR CODE	FEDERAL STOCK NUMBER	DESCRIPTION  REFERENCE NUMBER & MFR CODE	USABLE ON CODE	(4) UNIT OF MEAS	(5) QTY INC IN UNIT	(6) 30-DAY DS MAINT ALLOWANCE			(7) 30-DAY GS MAINT ALLOWANCE			(8) 1 YR ALW PER EQUIP COM- TGCY	(9) DEPOT MAINT ALW PER 100 EQUIP	(10) ILLUSTRATIONS	
						(A)	(B)	(C)	(A)	(B)	(C)			(A) FIG NO	(B) ITEM NO OR REFERENCE DESIGNATION
						1-20	21-50	51-100	1-20	21-50	51-100				
P--H-- A294		... TERMINAL, FEEDTHRU, INSULATED: SAME AS A289		EA	1				REF	REF	REF	REF	REF	12	A3A2E6
P--H-- A295	5940-644-8722	... TERMINAL, LUG: 4007-4HT(77147)		EA	1				*	*	*	*	*	12	A3A2E7
P--H-- A296	5310-938-2013	... NUT, PLAIN, HEXAGON: MS35649-224(96906)		EA	1				*	*	*	*	*	12	A3A2E7H1
P--H-- A297	5305-054-5636	... SCREW, MACHINE: SAME AS A100		EA	1				REF	REF	REF	REF	REF	12	A3A2E7H2
P--H-- A298	5310-928-2690	... WASHER, LOCK: MS35338-134(96906)		EA	1				*	*	*	*	*	12	A3A2E7H3
P--H-- A299	5940-644-8722	... TERMINAL, LUG: SAME AS A295		EA	1				REF	REF	REF	REF	REF	12	A3A2E8
P--H-- A300	5310-938-2013	... NUT, PLAIN, HEXAGON: SAME AS A296		EA	1				REF	REF	REF	REF	REF	12	A3A2E8H1
P--H-- A301	5305-054-5636	... SCREW, MACHINE: SAME AS A100		EA	1				REF	REF	REF	REF	REF	12	A3A2E8H2
P--H-- A302	5310-928-2690	... WASHER, LOCK: SAME AS A298		EA	1				REF	REF	REF	REF	REF	12	A3A2E8H3
P--H-- A303	5940-836-3536	... TERMINAL, LUG: 4040-2HDSPL(77147)		EA	1				*	*	*	*	*	11	A3A2E9
P--H-- A304	5310-938-2013	... NUT, PLAIN, HEXAGON: SAME AS A296		EA	1				REF	REF	REF	REF	REF	11	A3A2E9H1
P--H-- A305	5305-054-5636	... SCREW, MACHINE: SAME AS A100		EA	1				REF	REF	REF	REF	REF	11	A3A2E9H2
P--H-- A306	5310-928-2690	... WASHER, LOCK: SAME AS A298		EA	1				REF	REF	REF	REF	REF	11	A3A2E9H3
P--H-- A307	5940-682-9416	... TERMINAL, LUG: 4040-5HDSPL(77147)		EA	1				*	*	*	*	*	12	A3A2E10
P--H-- A308	5940-682-9416	... TERMINAL, LUG: SAME AS A307		EA	1				REF	REF	REF	REF	REF	12	A3A2E11
P--H-- A309	5940-682-9416	... TERMINAL, LUG: SAME AS A307		EA	1				REF	REF	REF	REF	REF	12	A3A2E12
P--H-- A310		... TERMINAL, STUD: SL147-322WHT(12615)		EA	1				*	*	*	*	*	12	A3A2E13
P--H-- A311		... TERMINAL, STUD: SAME AS A310		EA	1				REF	REF	REF	REF	REF	12	A3A2E14
P--H-- A312	5950-944-5371	... TRANSFORMER, POWER, STEP-UP: 38164(73386)		EA	1				*	*	*	*	*	11	A3A2T1
P--H-- A313	5305-054-5646	... SCREW, MACHINE: MS51957-14(96906)		EA	4				*	*	*	*	*	11	A3A2T1H1
P--H-- A314	5310-933-8118	... WASHER, LOCK: SAME AS A039		EA	4				REF	REF	REF	REF	REF	11	A3A2T1H2
P--H-- A315	5961-192-6230	... TRANSISTOR: 39179(02735)		EA	1				*	*	*	*	*	12	A3A2Q1
P--H-- A316	5970-910-3528	... INSULATOR, WASHER: MW375-140(08289)		EA	2				*	*	*	*	*	12	A3A2Q1H1
P--H-- A317	5970-023-6246	... MOUNTING KIT, SEMICONDUCTOR DEVICE: TA2402A(08289)		EA	1				*	*	*	*	*	12	A3A2Q1H2
P--H-- A318	5310-208-3786	... NUT, PLAIN, HEXAGON: SAME AS A109		EA	2				REF	REF	REF	REF	REF	12	A3A2Q1H3
P--H-- A319	5305-054-5647	... SCREW, MACHINE: SAME AS A037		EA	2				REF	REF	REF	REF	REF	12	A3A2Q1H4

## SECTION II. REPAIR PARTS FOR DIRECT SUPPORT, GENERAL SUPPORT, AND DEPOT MAINTENANCE (CONTINUED)

SMR CODE	FEDERAL STOCK NUMBER	DESCRIPTION REFERENCE NUMBER & MFR CODE	USABLE ON CODE	(4) UNIT OF MEAS	(5) QTY INC IN UNIT	(6) 30-DAY DS MAINT ALLOWANCE			(7) 30-DAY GS MAINT ALLOWANCE			(8) 1 YR ALW PER EQUIP COM- TGCY	(9) DEPOT MAINT ALW PER 100 EQUIP	(10) ILLUSTRATIONS	
						(A)	(B)	(C)	(A)	(B)	(C)			(A)	(B)
						1-20	21-50	51-100	1-20	21-50	51-100			FIG NO	ITEM NO OR REFERENCE DESIGNATION
P--H-- A320	5970-933-3697	...SPACER,INSULATING: TW135-175-40(08289)		EA	2				*	*	*	*	*	12	A3A2Q1H5
P--H-- A321	5310-782-1349	...WASHER,FLAT: 310-0045-000(79807)		EA	2				*	*	*	*	*	12	A3A2Q1H6
P--H-- A322	5310-933-8118	...WASHER,LOCK: SAME AS A039		EA	2				REF	REF	REF	REF	REF	12	A3A2Q1H7
P--H-- A323	5961-192-6230	...TRANSISTOR: SAME AS A315		EA	1				REF	REF	REF	REF	REF	11	A3A2Q2
P--H-- A324	5970-910-3528	...INSULATOR,WASHER: SAME AS A316		EA	2				REF	REF	REF	REF	REF	11	A3A2Q2H1
P--H-- A325	5970-023-6246	...MOUNTING KIT, SEMICONDUCTOR DEVICE: SAME AS A317		EA	1				REF	REF	REF	REF	REF	11	A3A2Q2H2
P--H-- A326	5310-208-3786	...NUT,PLAIN,HEXAGON: SAME AS A109		EA	2				REF	REF	REF	REF	REF	11	A3A2Q2H3
P--H-- A327	5305-054-5647	...SCREW,MACHINE: SAME AS A037		EA	2				REF	REF	REF	REF	REF	11	A3A2Q2H4
P--H-- A328	5970-933-3697	...SPACER,INSULATING: SAME AS A320		EA	2				REF	REF	REF	REF	REF	11	A3A2Q2H5
P--H-- A329	5310-782-1349	...WASHER,FLAT: SAME AS A321		EA	2				REF	REF	REF	REF	REF	11	A3A2Q2H6
P--H-- A330	5310-933-8118	...WASHER,LOCK: SAME AS A039		EA	2				REF	REF	REF	REF	REF	11	A3A2Q2H7
P--H-- A331	5961-192-6230	...TRANSISTOR: SAME AS A315		EA	1				REF	REF	REF	REF	REF	11	A3A2Q3
P--H-- A332	5970-910-3528	...INSULATOR,WASHER: SAME AS A316		EA	2				REF	REF	REF	REF	REF	11	A3A2Q3H1
P--H-- A333	5970-023-6246	...MOUNTING KIT, SEMICONDUCTOR DEVICE: SAME AS A317		EA	1				REF	REF	REF	REF	REF	11	A3A2Q3H2
P--H-- A334	5310-208-3786	...NUT,PLAIN,HEXAGON: SAME AS A109		EA	2				REF	REF	REF	REF	REF	11	A3A2Q3H3
P--H-- A335	5305-054-5647	...SCREW,MACHINE: SAME AS A037		EA	2				REF	REF	REF	REF	REF	11	A3A2Q3H4
P--H-- A336	5970-933-3697	...SPACER,INSULATING: SAME AS A320		EA	2				REF	REF	REF	REF	REF	11	A3A2Q3H5
P--H-- A337	5310-782-1349	...WASHER,FLAT: SAME AS A321		EA	2				REF	REF	REF	REF	REF	11	A3A2Q3H6
P--H-- A338	5310-933-8118	...WASHER,LOCK: SAME AS A039		EA	2				REF	REF	REF	REF	REF	11	A3A2Q3H7
A--H--S A339	6625-871-7556	...SIMULATOR,LOOP,ANTENNA CIRCUIT: 762-1774-001(13499)		EA	1									8	A3A3
P--H-- A340	5305-054-6651	...SCREW,MACHINE: SAME AS A106		EA	2				REF	REF	REF	REF	REF	8	A3A3H1
P--H-- A341	5910-811-5155	...CAPACITORMFIXED,MICA DIELECTRIC: DM15F431G300W4CR(72136)		EA	1				*	*	*	*	*	8	A3A3C1
P--H-- A342	5910-487-8424	...CAPACITOR,FIXED,MICA DIELECTRIC: CM05FD391J03(81349)		EA	1				*	*	*	*	*	8	A3A3C2
P--H-- A343	5910-811-5155	...CAPACITOR,FIXED,MICA DIELECTRIC: SAME AS A341		EA	1				REF	REF	REF	REF	REF	8	A3A3C3

SECTION II. REPAIR PARTS FOR DIRECT SUPPORT, GENERAL SUPPORT, AND DEPOT MAINTENANCE (CONTINUED)															
(1)	(2)	(3)	(4)	(5)	(6)	(7)			(8)	(9)	(10)				
SMR CODE	FEDERAL STOCK NUMBER	DESCRIPTION	USABLE ON CODE	UNIT OF MEAS	QTY INC IN UNIT	30-DAY DS MAINT ALLOWANCE			30-DAY GS MAINT ALLOWANCE			1 YR ALW PER EQUIP COM-TGCY	DEPOT MAINT ALW PER 100 EQUIP	ILLUSTRATIONS	(A) (B) ITEM NO OR REFERENCE DESIGNATION
		REFERENCE NUMBER & MFR CODE				(A)	(B)	(C)	(A)	(B)	(C)				
P--H-- A344	5910-487-8424	...CAPACITOR, FIXED, MICA DIELECTRIC: SAME AS A342		EA	1				REF	REF	REF	REF	REF	8	A3A3C4
M--D-- A345		...CHASSIS, ELECTRICAL EQUIPMENT: 549-6450-004(13499)		EA	1									8	A3A3MP1
P--H-- A346	5325-135-3395	...EYELET, METALLIC: A1444BRSH(5771)		EA	2				*	*	*	*	*	8	A3A3MP1H1
P--H-- A347	5950-707-1243	...COIL, RADIO FREQUENCY: LT4K093(81349)		EA	1				*	*	*	*	*	8	A3A3L1
P--H-- A348	5950-899-9359	...COIL, RADIO FREQUENCY: MS18130-21(96906)		EA	1				*	*	*	*	*	8	A3A3L2
P--H-- A349	5950-930-5935	...COIL, RADIO FREQUENCY: 549-6541-003(13499)		EA	1				*	*	*	*	*	8	A3A3L3
P--H-- A350	5950-899-9359	...COIL, RADIO, FREQUENCY: SAME AS A348		EA	1				REF	REF	REF	REF	REF	8	A3A3L4
P--H-- A351	5950-707-1243	...COIL, RADIO FREQUENCY: SAME AS A347		EA	1				REF	REF	REF	REF	REF	8	A3A3L5
P--H-- A352	5950-707-1243	...COIL, RADIO FREQUENCY: SAME AS A347		EA	1				REF	REF	REF	REF	REF	8	A3A3L6
P--H-- A353	5950-899-9359	...COIL, RADIO FREQUENCY: SAME AS A348		EA	1				REF	REF	REF	REF	REF	8	A3A3L7
P--H-- A354	5950-899-9359	...COIL, RADIO FREQUENCY: SAME AS A348		EA	1				REF	REF	REF	REF	REF	8	A3A3L8
P--H-- A355	5950-707-1234	...COIL, RADIO FREQUENCY: SAME AS A347		EA	1				REF	REF	REF	REF	REF	8	A3A3L9
P--H-- A356	5950-930-5935	...COIL, RADIO FREQUENCY: SAME AS A349		EA	1				REF	REF	REF	REF	REF	8	A3A3L10
P--H-- A357	5935-685-9861	...CONNECTOR, RECEPTACLE, ELECTRICAL: PT02A12-10P(77820)		EA	1				*	*	*	*	*	8	A3A3J2
P--H-- A358	5305-637-5884	...SCREW, MACHINE: P343-0285-000(77250)		EA	4				*	*	*	*	*	8/	A3A3J2H1
M--D-- A359		...PLATE, CHASSIS-BOTTOM: 549-6444-003(13499)		EA	1									8	A3A3MP2
P--H-- A360	5305-206-1270	...SCREW, MACHINE: P343-0284-000(77250)		EA	4				*	*	*	*	*	8	A3A3MP2H1
P--H-- A361	5310-591-3416	...WASHER, FLAT: 310-0054-000(79807)		EA	4				*	*	*	*	*	8	A3A3MP2H2
P--H-- A362	5310-184-8996	...WASHER, SPRING TENSION: 310-0076-000(79807)		EA	4				*	*	*	*	*	8	A3A3MP2H3
M--D-- A363		...PLATE, MOUNTING-LARGE, PRESSED: 549-6436-003(13499)		EA	1									8	A3A3MP3
P--H-- A364	5310-682-5993	...NUT, SELF-LOCKING, CLINCH: F22NCFMA2-40(72962)		EA	1				*	*	*	*	*	8	A3A3MP3H1
P--H-- A365	5310-866-3506	...NUT, SELF-LOCKING, CLINCH: SAME AS A023		EA	2				REF	REF	REF	REF	REF	8	A3A3MP3H2
P--H-- A366	5940-644-8722	...TERMINAL, LUG: SAME AS A295		EA	1				REF	REF	REF	REF	REF	8	A3A3E1
P--H-- A367	5310-530-9214	...NUT, PLAIN, HEXAGON: F313-0051-000(77250)		EA	1				*	*	*	*	*	8	A3A3E1H1

SECTION II. REPAIR PARTS FOR DIRECT SUPPORT, GENERAL SUPPORT, AND DEPOT MAINTENANCE (CONTINUED)

SMR CODE	FEDERAL STOCK NUMBER	DESCRIPTION  REFERENCE NUMBER & MFR CODE	USABLE ON CODE	(4) UNIT OF MEAS	(5) QTY INC IN UNIT	(6) 30-DAY DS MAINT ALLOWANCE			(7) 30-DAY GS MAINT ALLOWANCE			(8) 1 YR ALW PER EQUIP COM- TCCY	(9) DEPOT MAINT ALW PER 100 EQUIP	(10) ILLUSTRATIONS	
						(A)	(B)	(C)	(A)	(B)	(C)	FIG NO	(B) ITEM NO OR REFERENCE DESIGNATION		
						1-20	21-50	51-100	1-20	21-50	51-100				
P--H-- A368	5305-637-5884	...SCREW,MACHINE: SAME AS A358		EA	1				REF	REF	REF	REF	REF	8	A3A3E1H2
P--H-- A369	5310-184-8996	...WASHER,SPRING TENSION: SAME AS A362		EA	1				REF	REF	REF	REF	REF	8	A3A3E1H3
P--H-- A370	5940-644-8722	...TERMINAL,LOG: SAME AS A295		EA	1				REF	REF	REF	REF	REF	8	A3A3E2
P--H-- A371	5310-530-9214	...NUT,PLAIN,HEXAGON: SAME AS A367		EA	1				REF	REF	REF	REF	REF	8	A3A3E2H1
P--H-- A372	5305-637-5884	...SCREW,MACHINE: SAME AS A358		EA	1				REF	REF	REF	REF	REF	8	A3A3E2H2
P--H-- A373	5310-184-8996	...WASHER,SPRING TENSION: SAME AS A362		EA	1				REF	REF	REF	REF	REF	8	A3A3E2H3
P--H-- A374	5940-644-8722	...TERMINAL,LOG: SAME AS A295		EA	1				REF	REF	REF	REF	REF	8	A3A3E3
P--H-- A375	5310-530-9214	...NUT,PLAIN,HEXAGON: SAME AS A367		EA	1				REF	REF	REF	REF	REF	8	A3A3E3H1
P--H-- A376	5305-637-5884	...SCREW,MACHINE: SAME AS A358		EA	1				REF	REF	REF	REF	REF	8	A3A3E3H2
P--H-- A377	5310-184-8996	...WASHER,SPRING,TENSION: SAME AS A362		EA	1				REF	REF	REF	REF	REF	8	A3A3E3H3
P--H-- A378	5985-912-0193	...SIMULATOR,LOOP,ANTENNA POSITION: 300101(24363)		EA	1				*	*	*	*	*	13	A3DS4
P--H-- A379	5310-616-8660	...NUT,PLAIN,HEXAGON: SAME AS A049		EA	3				REF	REF	REF	REF	REF	6	A3DS4H1
P--H-- A380	5305-059-8255	...SCREW,MACHINE: SAME AS A231		EA	3				REF	REF	REF	REF	REF	6	A3DS4H2
P--H-- A381	5310-616-3555	...WASHER,LOCK: SAME AS A128		EA	3				REF	REF	REF	REF	REF	6	A3DS4H3
X1-H-- A382		...COVER,FRONT: 100104(24363)		EA	1									13	A3DS4MP25
X1-H-- A383		...DIAL: SAME AS A238		EA	1									13	A3DS4MP11
X1-H-- A384		...DOWEL PIN: 100135(24363)		EA	1									13	A3DS4MP26
X1-H-- A385		...FRONT COVER SUBASSEMBLY: 100141(24363)		EA	1									13	A3DS4MP4
X1-H-- A386		...GASKET,CASE: 100127(24363)		EA	1									13	A3DS4MP20
X1-H-- A387		...SCREW,MACHINE: SAME AS A243		EA	8									13	A3DS4MP20H23
X1-H-- A388		...WASHER,LOCK: SAME AS A242		EA	8									13	A3DS4MP20H22
X1-H-- A389		...GEAR,DRIVE: 100110(24263)		EA	1									13	A3DS4MP6
X1-H-- A390		...GEAR,IDLER: 100109(24363)		EA	1									13	A3DS4MP14
X1-H-- A391		...GEAR,SYNCHRO: 100107(24363)		EA	1									13	A3DS4MP12
X1-H-- A392		...GLASS: SAME AS A240		EA	1									13	A3DS4MP8
X1-H-- A393		...HOUSING,REAR: 100130(24363)		EA	1									13	A3DS4MP21

## SECTION II. REPAIR PARTS FOR DIRECT SUPPORT, GENERAL SUPPORT, AND DEPOT MAINTENANCE (CONTINUED)

SMR CODE	FEDERAL STOCK NUMBER	DESCRIPTION  REFERENCE NUMBER & MFR CODE	USABLE ON CODE	(4) UNIT OF MEAS	(5) QTY INC IN UNIT	(6) 30-DAY DS MAINT ALLOWANCE			(7) 30-DAY GS MAINT ALLOWANCE			(8) 1 YR ALW PER EQUIP COM- TGCY	(9) DEPOT MAINT ALW PER 100 EQUIP	(10) ILLUSTRATIONS	
						(A)	(B)	(C)	(A)	(B)	(C)			(A)	(B)
						1-20	21-50	51-100	1-20	21-50	51-100			FIG NO	ITEM NO OR REFERENCE DESIGNATION
X1-H-- A394		...HOUSING, SYNCHRO: 100103-2(24363)		EA	1									13	A3DS4MP15
X1-H-- A395		...KNOB 100113(24363)		EA	1									13	A3DS4MP1
X1-H-- A396		...SETSCREW: 100108-2(24363)		EA	2									13	A3DS4MP1H2
X1-H-- A397		...WASHERFLAT: 100114(24363)		EA	1									13	A3DS4MP1H3
X1-H-- A398		...NAMEPLATE: 100120-3(24363)		EA	1									13	A3DS4MP24
X1-H-- A399		...POINTER: SAME AS A246		EA	1									13	A3DS4MP10
X1-H-- A400		...SETSCREW: 100108-1(24363)		EA	2									13	A3DS4MP10H13
X1-H-- A401		...RESOLVER: 300121(24363)		EA	1									13	A3DS4MP19
X2-H-- A402		...CLAMP, SYNCHRO: SAME AS A250		EA	3									13	A3DS4MP19MP16
X1-H-- A403		...WASHERLOCK: SAME AS A235		EA	3									13	A3DS4MP19H17
X1-H-- A404		...SCREW MACHINE: SAME AS A236		EA	3									13	A3DS4MP19H18
X1-H-- A405		...RETAINER, DIAL: SAME AS A247		EA	1									13	A3DS4MP9
X1-H-- A406		...ROLL PIN: 100134(24363)		EA	1									13	A3DS4MP27
X1-H-- A407		...SEAL, WINDOW: SAME AS A248		EA	1									13	A3DS4MP7
X1-H-- A408		...SHAFT, SLEEVE: 100125(24363)		EA	1									13	A3DS4MP5
X1-H-- A409		...STUD, GEAR: 100132-1(24363)		EA	1									13	A3DS4MP28
A--H-S A410	5826-985-9174	...CONTROL BOX, AUTOMATIC DIRECTION FINDER: C6899ARN-83(80058)  NOTE: SEE TM11-5826-225-35P, FIG. 2 ASSEMBLY A2 FOR PARTS DESCRIPTION AND ILLUSTRATION.		EA	1									1	A3A4
X2-H-- A603	6145-284-0866	...BRAID, WIRE, TINNED COPPER; 96 STRAND; 16 AWG; 5/32 IN. WIDE; 7/64 IN. I.D.; 36109(75818)		FT	V									1	W5
X2-H-- A604	6145-669-5551	...BRAID, WIRE, TINNED COPPER; 384 STRAND; 10 AWG; 9/16 IN. WIDE; 3/8 IN. I.D.; 5064(70903)		FT	V									1	W6
X2-H-- A605		...CABLE, RADIO FREQUENCY; BLACK JACKET; COPPER COVERED STEEL; 7 STRAND; 34 AWG; 93 OHM COAXIAL; RG62BU (80058)		FT	V									1	W7
X2-H-- A606	6145-184-4325	...CABLE, SPECIAL PURPOSE, ELECTRICAL/MICROPHONE TYPE; 16 STRAND; 2 TWISTED 22 AWG, COVERED BY TINNED COPPER BRAID; 0.231 IN. OVERALL VINYL JACKET; 8422(70903)		FT	V									1	W8



SECTION II. REPAIR PARTS FOR DIRECT SUPPORT, GENERAL SUPPORT, AND DEPOT MAINTENANCE (CONTINUED)															
(1)	(2)	(3)	(4)	(5)	(6)			(7)			(8)	(9)	(10)		
SMR CODE	FEDERAL STOCK NUMBER	DESCRIPTION	USABLE ON CODE	UNIT OF MEAS	QTY INC	30-DAY DS MAINT ALLOWANCE			30-DAY GS MAINT ALLOWANCE			1 YR ALW PER EQUIP COM-TGCY	DEPOT MAINT ALW PER EQUIP	ILLUSTRATIONS (A) FIG NO	(B) ITEM NO OR REFERENCE DESIGNATION
		REFERENCE NUMBER & MFR CODE				(A)	(B)	(C)	(A)	(B)	(C)				
X2-H-- A607	6145-161-0913	..CABLE,RADIO FREQUENCY; COAXIAL TYPE;COPPER COVERED STEEL WIRE;INNER CONDUCTOR; 34AWG BARE COPPER ..WIRE, OUTER CONDUCTOR;0.242 IN. OVERALL DIAMETER JACKET; RG62AU(80058)		FT	V									1	W9
X2-H-- A608	6145-838-9444	..WIRE,ELECTRICAL;TIN PLATED; 26 AWG;SOLID COPPER WIRE; 421-0074-000(94130)		FT	V									1	W10
X2-H-- A609	6145-160-4775	..WIRE,ELECTRICAL;TIN PLATED; 22 AWG;SOLID COPPER WIRE; SAME AS A572		FT	V									1	W11
X2-H-- A610	6145-577-3420	..WIRE,ELECTRICAL;TIN PLATED; 24 AWG;SOLID COPPER WIRE; QQW343TTPESAWG24(90484)		FT	V									1	W12
X2-H-- A611	6145-542-6092	..CABLE,RADIO FREQUENCY; COAXIAL TYPE;19 STRAND TINNED COPPER ..WIRE,INNER CONDUCTOR;36 AWG SINGLE BRAID,OUTER CONDUCTOR; 0.195 IN.OVERALL DIA. BLACK JACKET; RG58CU(80058)		FT	V									1	W13
X2-H-- A612		..WIRE,ELECTRICAL;CLEAR OR WHITE;22 AWG;SOLID,SILVER PLATE COPPER WIRE; WTE22A(90484)		FT	V									1	W14
X2-H-- A613	6145-548-0969	..WIRE,ELECTRICAL;WHITE; 7 STRAND;22 AWG;SILVER PLATED,COPPER CONDUCTORS; LXT22730-9(12515)		FT	V									1	W15
X2-4-- A614		..WIRE,ELECTRICAL;WHITE WITH BLACK TRACER;7 STRAND; 22 AWG,SILVER PLATED, COPPER CONDUCTORS; LXT22730-90(12515)		FT	V									1	W16
X2-H-- A615	6145-686-4941	..WIRE,ELECTRICAL;WHITE WITH BROWN TRACER; 7 STRAND;22 AWG;SILVER PLATED,COPPER CONDUCTORS; LXT22730-91 (12515)		FT	V									1	W17
X2-H-- A616		..WIRE,ELECTRICAL;WHITE WITH RED TRACER;7 STRAND;22 AWG; SILVER PLATED,COPPER CONDUCTORS; LXT22730-92 (12515)		FT	V									1	W18
X2-H-- A617	6145-686-4939	..WIRE,ELECTRICAL;WHITE WITH ORANGE TRACER,7 STRAND;22 AWG;SILVER PLATED,COPPER CONDUCTORS; LXT22730-93(12515)		FT	V									1	W19
X2-H-- A618		..WIRE,ELECTRICAL;WHITE WITH GREEN TRACER;7 STRAND; 22 AWG;SILVER PLATED, COPPER CONDUCTORS; LXT22730-95(12515)		FT	V									1	W20
X2-H-- A619	6145-686-4937	..WIRE,ELECTRICAL;WHITE WITH BLUE TRACER;7 STRAND; 22 AWG; SILVER PLATED, COPPER CONDUCTORS; LXT22730-96(12515)		FT	V									1	W21

## SECTION II. REPAIR PARTS FOR DIRECT SUPPORT, GENERAL SUPPORT, AND DEPOT MAINTENANCE (CONTINUED)

SMR CODE	FEDERAL STOCK NUMBER	DESCRIPTION  REFERENCE NUMBER & MFR CODE	USABLE ON CODE	(4) UNIT OF MEAS	(5) QTY INC IN UNIT	(6) 30-DAY DS MAINT ALLOWANCE			(7) 30-DAY GS MAINT ALLOWANCE			(8) 1 YR ALW PER EQUIP COM- TGCY	(9) DEPOT MAINT ALW PER 100 EQUIP	(10) ILLUSTRATIONS	
						(A)	(B)	(C)	(A)	(B)	(C)			(A)	(B)
						1-20	21-50	51-100	1-20	21-50	51-100			FIG NO	ITEM NO OR REFERENCE DESIGNATION
X2-H-- A620		..WIRE, ELECTRICAL; WHITE WITH BLACK AND RED TRACER; 7 STRAND; 22 AWG; SILVER PLATED, COPPER CONDUCTORS; LXT22730-902 (12515)		FT	V									1	W22
X2-H-- A621	6145-060-9083	..WIRE, ELECTRICAL; WHITE WITH BLACK AND ORANGE TRACER; 7 STRAND; 22 AWG; SILVER PLATE, COPPER CONDUCTORS; LXT22730-903 (12515)		FT	V									1	W23
X2-H-- A622	6145-841-2913	..WIRE, ELECTRICAL; WHITE WITH BLACK AND GREEN TRACER; 7 STRAND; 22 AWG; SILVER PLATED, COPPER CONDUCTORS; LXT22730-905 (12515)		FT	V									1	W24
X2-H-- A623	6145-686-5274	..WIRE, ELECTRICAL; WHITE WITH BLACK AND BLUE TRACER; 7 STRAND; 22 AWG; SILVER PLATE, COPPER CONDUCTORS; LXT22730-906 (12515)		FT	V									1	W25
X2-H-- A624	6145-060-9078	..WIRE, ELECTRICAL; WHITE WITH BROWN AND RED TRACER; 7 STRAND; 22 AWG; SILVER PLATED, COPPER CONDUCTORS; LXT22730-912 (12515)		FT	V									1	W26
X2-H-- A625	6145-686-4954	..WIRE, ELECTRICAL; WHITE WITH BROWN AND ORANGE TRACER; 7 STRAND; 22 AWG; SILVER PLATED, COPPER CONDUCTORS; LXT22730-913 (12515)		FT	V									1	W27
X2-H-- A626	6145-841-3247	..WIRE, ELECTRICAL; WHITE WITH BROWN AND GREEN TRACER; 7 STRAND; 22 AWG; SILVER PLATED, COPPER CONDUCTORS; LXT22730-915 (12515)		FT	V									1	W28
X2-H-- A627	6145-928-9896	..WIRE, ELECTRICAL; WHITE WITH BROWN AND BLUE TRACER; 7 STRAND; 22 AWG; SILVER PLATED, COPPER CONDUCTORS; LXT22730-916 (12515)		FT	V									1	W29
X2-H-- A628	6145-686-4952	..WIRE, ELECTRICAL; WHITE WITH RED AND ORANGE TRACER; 7 STRAND; 22 AWG; SILVER PLATED, COPPER CONDUCTORS; LXT22730-923 (12515)		FT	V									1	W30
X2-H-- A629	6145-952-1735	..WIRE, ELECTRICAL; WHITE WITH RED AND GREEN TRACER; 7 STRAND; 22 AWG; SILVER PLATED, COPPER CONDUCTORS; LXT22730-925 (12515)		FT	V									1	W31
X2-H-- A630		..WIRE, ELECTRICAL; WHITE WITH RED AND BLUE TRACER; 7 STRAND; 22 AWG; SILVER PLATED, COPPER CONDUCTORS; LXT22730-926 (12515)		FT	V									1	W32
X2-H-- A631	6145-686-4917	..WIRE, ELECTRICAL; WHITE WITH ORANGE AND GREEN TRACER; 7 STRAND; 22 AWG; SILVER PLATE, COPPER CONDUCTORS; LXT22730-935 (12515)		FT	V									1	W33
X2-H-- A632	6145-686-4916	..WIRE, ELECTRICAL; WHITE WITH ORANGE AND BLUE TRACER; 7 STRAND; 22 AWG; SILVER PLATED, COPPER CONDUCTORS; LXT22730-936 (12515)		FT	V									1	W34

SECTION II. REPAIR PARTS FOR DIRECT SUPPORT, GENERAL SUPPORT, AND DEPOT MAINTENANCE (CONTINUED)

SMR CODE	FEDERAL STOCK NUMBER	DESCRIPTION REFERENCE NUMBER & MFR CODE	USABLE ON CODE	(4) UNIT OF MEAS	(5) QTY INC IN UNIT	(6) 30-DAY DS MAINT ALLOWANCE			(7) 30-DAY GS MAINT ALLOWANCE			(8) 1 YR ALW PER EQUIP COM-TGCY	(9) DEPOT MAINT ALW PER EQUIP	(10) ILLUSTRATIONS	
						(A)	(B)	(C)	(A)	(B)	(C)			(A)	(B)
						1-20	21-50	51-100	1-20	21-50	51-100			FIG NO	ITEM NO OR REFERENCE DESIGNATION
X2-H-- A633		..WIRE, ELECTRICAL; WHITE WITH ORANGE, GREEN, AND BLUE TRACER; 7 STRAND; 22 AWG; SILVER PLATED, COPPER CONDUCTORS; LXT22730-9356(12515)		FT	V									1	W35
X2-H-- A634	6145-754-8057	..WIRE, ELECTRICAL; BLACK; 7 STRAND; 22 AWG; SILVER PLATED, COPPER CONDUCTORS; LXT22730-0(12515)		FT	V									1	W36
X2-H-- A635	6145-623-7224	..WIRE, ELECTRICAL; RED; 7 STRAND; 22 AWG; SILVER PLATED, COPPER CONDUCTORS; LXT22730-2(12515)		FT	V									1	W37
X2-H-- A636	6145-754-8058	..WIRE, ELECTRICAL; ORANGE; 7 STRAND; 22 AWG; SILVER PLATED, COPPER CONDUCTORS; IXT22730-3(12515)		FT	V									1	W38
X2-H-- A637	6145-623-7225	..WIRE, ELECTRICAL; GREEN; 7 STRAND; 22 AWG; SILVER PLATED, COPPER CONDUCTORS; LXT22730-5(12515)		FT	V									1	W39
X2-H-- A638	6145-578-6824	..WIRE, ELECTRICAL; BLUE; 7 STRAND; 22 AWG; SILVER PLATED, COPPER CONDUCTORS; LXT22730-6(12515)		FT	V									1	W40
X2-H-- A639	6145-581-9324	..WIRE, ELECTRICAL; BROWN; 7 STRAND; 22 AWG; SILVER PLATED, COPPER CONDUCTORS; LXT22730-1(12515)		FT	V									1	W41
X2-H-- A640	6145-557-3591	..WIRE, ELECTRICAL; YELLOW; 7 STRAND; 22 AWG; SILVER PLATED, COPPER CONDUCTORS; LXT22730-4(12515)		FT	V									1	W42
X2-H-- A641	6145-578-6978	..WIRE, ELECTRICAL; GRAY; 7 STRAND; 22 AWG; SILVER PLATED, COPPER CONDUCTORS; LXT22730-8(12515)		FT	V									1	W43
X2-H-- A642		..WIRE, ELECTRICAL; BLACK WITH ORANGE TRACER; 7 STRAND; 22 AWG; SILVER PLATED, COPPER CONDUCTORS; LXT22730-03(12515)		FT	V									1	W44
X2-H-- A643	6145-578-6975	..WIRE, ELECTRICAL; VIOLET; 7 STRAND; 22 AWG; SILVER PLATED, COPPER CONDUCTORS; LXT22730-7(12515)		FT	V									1	W45
X2-H-- A644	6145-916-9561	..WIRE, ELECTRICAL; WHITE AND BLACK SHIELDED-PAIR OF 7 STRAND, SILVER PLATED, COPPER WIRE; 30 AWG; 439-5275-000(05973)		FT	V									1	W46
X2-H-- A645		..WIRE, ELECTRICAL; WHITE AND RED SHIELDED PAIR OF 7 STRAND, SILVER PLATED, COPPER WIRE; 30 AWG; 439-5277-000(05973)		FT	V									1	W47
X2-H-- A646	6145-669-6710	..WIRE, ELECTRICAL; WHITE; 7 STRAND TINNED COPPER WIRE ; 20 AWG; MILW1676TYPEB20-9(81349)		FT	V									1	W48

## SECTION II. REPAIR PARTS FOR DIRECT SUPPORT, GENERAL SUPPORT, AND DEPOT MAINTENANCE (CONTINUED)

(1)	(2)	(3)	(4)	(5)	(6)			(7)			(8)	(9)	(10)			
SMR CODE	FEDERAL STOCK NUMBER	DESCRIPTION	USABLE ON CODE	UNIT OF MEAS	QTY INC	30-DAY DS MAINT ALLOWANCE			30-DAY GS MAINT ALLOWANCE			1 YR ALW PER EQUIP COM-	DEPOT MAINT ALW PER 100 EQUIP	(A) FIG NO	(B) ITEM NO OR REFERENCE DESIGNATION	
		REFERENCE NUMBER & MFR CODE				(A)	(B)	(C)	(A)	(B)	(C)	TGCY				
X2-H-- A647	6145-803-0663	..WIRE, ELECTRICAL; RED; 7 STRAND TINNED COPPER WIRE; 20 AWG; MILW16878TYPEB20-2(81349)		FT	V									1	W49	
X2-H-- A648	6145-080-1819	..WIRE, ELECTRICAL; GREEN; 7 STRAND SILVER PLATED COPPER WIRE; 22 AWG; 22499-673B1-5(92607)		FT	V									1	W50	
X2-H-- A649		..WIRE, ELECTRICAL; YELLOW; 7 STRAND SILVER PLATED COPPER WIRE; 22 AWG; 22499-673B1-4(92607)		FT	V									1	W51	

## SECTION III. INDEX-FEDERAL STOCK NUMBER AND REFERENCE NUMBER

## CROSS REFERENCE TO FIGURE AND ITEM NUMBER

FEDERAL STOCK NUMBER	FIGURE NUMBER	ITEM NUMBER OR REF DESIGNATION	FEDERAL STOCK NUMBER	FIGURE NUMBER	ITEM NUMBER OR REF DESIGNATION
53050545635	3	A1A1MP9H1	53106163555	9	A3MP14H2
53050545635	5	A2MP18H1	53106163555	6	A3DS3H3
53050545635	6	A3MP13H1	53106163555	6	A3DS4H3
53050545636	5	A2E1H1	5310616866C	4	A1A1P2H1
53050545636	5	A2E2H1	5310616866C	4	A1A1P3H1
53050545636	12	A3A2E7H2	53106168660	4	A1A1P4H1
53050545636	12	A3A2E8H2	53106168660	4	A1A1P5H1
53050545636	11	A3A2E9H2	53106168660	6	A3DS3H1
53050545646	12	A3A2A1H2	53106168660	6	A3DS4H1
53050545646	11	AA3A2T1H1	53106768573	7	A3A1TB3H2
53050545647	3	A1A1MP6H1	53106825993	8	A3A3MP3H1
53050545647	8	A3A1R10H4	53107255323	8	A3A1R10H6
53050545647	1	A3W3P2H1	53107543071	5	A2MP19
53050545647	12	A3A2A1H3	53107821349	12	A3A2Q1H6
53050545647	12	A3A2Q1H4	53107821349	11	A3A2Q2H6
53050545647	11	A3A2Q2H4	53107821349	11	A3A2Q3H6
53050545647	11	A3A2Q3H4	53108110494	11	A3A2R1H2
53050545649	7	A3A1J7H2	53108151086	5	A2P1H1
53050545649	8	A3A1R10H5	53108575547	1	MP3MP1H1
53050545650	12	A3A2A2H2	53108575547	1	MP3MP2H1
53050545652	5	A2MP15H1	53108575547	1	MP3MP4H1
53050545652	5	A2MP19H1	53108575547	7	A3A1MP3H1
53050546651	6	A3H1	53108575547	7	A3A1MP4H1
53050546651	7	A3A1L11H1	53108663506	1	MP3MP2H3
53050546651	9	A3MP14H1	53108663506	8	A3A3MP3H2
53050546651	8	A3A3H1	53109248526	11	A3A2R1H1
53050546653	1	MP3MP1H2	53109282690	5	A2E1H2
53050546653	1	MP3MP2H2	53109282690	5	A2E2H2
53050546653	1	MP3MP4H2	53109282690	12	A3A2E7H3
53050546654	7	A3A1MP3H2	53109282690	12	A3A2E8H3
53050546654	7	A3A1MP4H2	53109282690	11	A3A2E9H3
53050546668	3	A1A1MP11H1	53109338118	3	A1A1MP6H3
53050546670	3	A1A1MP10H1	53109338118	5	A2MP15H2
53050598255	6	A3DS3H2	53109338118	5	A2MP19H2
53050598255	6	A3DS4H2	53109338118	12	A3A2A2H4
53052061270	8	A3A3MP2H1	53109338118	12	A3A2L1H3
53056375884	8	A3A3J2H1	53109338118	11	A3A2T1H2
53056375884	8	A3A3E1H2	53109338118	12	A3A2Q1H7
53056375884	8	A3A3E2H2	53109338118	11	A3A2Q2H7
53056375884	8	AA3A3E3H2	53109338118	11	A3A2Q3H7
53056806757	7	A3A1TB3H1	53109338119	3	A1A1MP10H3
53057637822	7	A3MP1H2	53109338119	3	A1A1MP11H2
53057637822	7	A3A1H2	53109382013	12	A3A2E7H1
53057702533	12	A3A2L1H2	53109382013	12	A3A2E8H1
53057702579	7	A3MP15H2	53109382013	11	A3A2E9H1
53057702579	7	A3MP16H2	53109826580	6	A3J10H1
53100506833	12	A3A2A1H1	53152210465	6	A3MP7H1
53101366133	3	A1A1MP6H2	53205840672	1	MP3MP5H1
53101848996	8	A3A3MP2H3	53208170728	1	A1MP12H1
53101848996	8	A3A3E1H3	53208170728	1	A1MP13H1
53101848996	8	A3A3E2H3	53250594584	6	A3MP7H2
53101848996	8	A3A3E3H3	53251353395	8	A3A3MP1H1
53102083786	7	A3MP1H1	53251370039	1	MP3MP4H4
53102083786	7	A3A1H1	53251714365	1	MP3MP5
53102083786	7	A3A1J7H1	53251745317	7	A3A1MP5
53102083786	7	A3MP15H1	53251745317	9	A3MP8
53102083786	7	A3MP16H1	53252636632	5	A2MP16
53102083786	12	A3A2L1H1	53252754476	2	W3MP1H1
53102083786	12	A3A2Q1H3	53252754476	2	W3MP2H1
53102083786	11	A3A2Q2H3	53252764993	9	A3MP9
53102083786	11	A3A2Q3H3	53403368164	7	A3A1MP4
53102084662	5	A2S1H1	53405980383	7	A3A1MP3
53102084662	8	A3A1R8H1	53407053136	9	A3MP14
53102084662	8	A3J5H1	53409005823	8	A3A1R10H3
53102084662	7	A3S4H1		6	A3MP10
53102091074	3	A1A1MP10H2	53555791210	6	A3MP11
53102096069	4	A1A1P2H2	53556169604	3	A1A1MP8
53102096069	4	A1A1P3H2	53558789454	5	A2MP1
53102096069	4	A1A1P4H2	53657178566	12	A3A2A2H3
53102096069	4	A1A1P5H2	58269859174	1	A3A4
53102751347	7	A3A1MP4H3	59050709383	12	A3A2R2
53103378329	1	MP3MP4H3	59051856966	7	A3A1R7
53105158243	6	A3H2	59052259389	7	A3A1R9
53105309214	8	A3A3E1H1	59052524018	12	A3A2R3
53105309214	8	A3A3E2H1	59052792672	12	A3A2R6
53105309214	8	A3A3E3H1	59055493752	8	A3A1R10
53105319514	1	MP3MP1H3	59056869997	7	A3A1R6
53105503715	7	A3MP1H3	59057550796	12	A3A2R4
53105503715	7	A3A1H3	59057550796	12	A3A2R5
53105503715	7	A3A1J7H3	59058999239	11	A3A2R1
53105503715	8	A3A1R10H7	59059135011	9	A3R1
53105503715	1	A3W3P2H2	59059177045	8	A3A1R8
53105503715	7	A3MP15H3	59059526025	9	A3R4
53105503715	7	A3MP16H3	59059526025	9	A3R5
53105913416	8	A3A3MP2H2	59059882317	9	A3R3
53105957154	5	A2S1H2	59059895545	9	A3R2
53105957154	8	A3A1R8H2	59100606266	4	A1A1C1
53105957154	8	A3J5H2	59101118593	11	A3A2C5
53105957154	7	A3S4H2	59102468602	8	A3C6
53106163555	7	A3A1L11H2	59104560797	5	A2C4

## SECTION III. INDEX-FEDERAL STOCK NUMBER AND REFERENCE NUMBER

## CROSS REFERENCE TO FIGURE AND ITEM NUMBER (CONTINUED)

FEDERAL STOCK NUMBER	FIGURE NUMBER	ITEM NUMBER OR REF DESIGNATION	FEDERAL STOCK NUMBER	FIGURE NUMBER	ITEM NUMBER OR REF DESIGNATION
59104878424	8	A3A3C2	59408473138	8	A3A1E1
59104878424	8	A3A3C4	59408473138	7	A3E3
59105427371	11	A3A2C6	59408778430	5	A2E1
59105427372	11	A3A2C6	59507071234	8	A3A3L9
59105427387	11	A3A2C1	59507071243	8	A3A3L1
59105427387	11	A3A2C3	59507071243	8	A3A3L5
59105427387	11	A3A2C4	59507071243	8	A3A3L6
59105427387	11	A3A2C6	59508999359	8	A3A3L2
59107265003	12	A3A2C8	59508999359	8	A3A3L4
59107265003	12	A3A2C9	59508999359	8	A3A3L7
59107284093	9	A3C1	59508999359	8	A3A3L8
59108115155	8	A3A3C1	59509305935	8	A3A3L3
59108115155	8	A3A3C3	59509305935	8	A3A3L10
59108120948	11	A3A2C2	59509445371	11	A3A2T1
59108120948	11	A3A2C6	59509453866	12	A3A2L1
59108145869	11	A3A2C6	59509593771	7	A3A1L11
59108384240	5	A2C1	59610576014	7	A3A1Q1
59108384240	5	A2C3	59611926230	12	A3A2Q1
59108387126	5	A2C1	59611926230	11	A3A2Q2
59109342922	11	A3A2C6	59611926230	11	A3A2Q3
59109545496	5	A2C3	59700236246	12	A3A2Q1H2
59109995669	5	A2C1	59700236246	11	A3A2Q2H2
59109995669	5	A2C3	59700236246	11	A3A2Q3H2
59109995669	5	A2C5	59702847900	8	A3A1R10H2
59202804465	6	A3F2	59707059527	8	A3A1R10H1
59202804465	6	A3F4	59709103528	12	A3A2Q1H1
59208779934	6	A3F1	59709103528	11	A3A2Q2H1
59208779934	6	A3F3	59709103528	11	A3A2Q3H1
59208929311	6	A3XF1	59709333697	12	A3A2Q1H5
59208929311	6	A3XF2	59709333697	11	A3A2Q2H5
59208929311	6	A3XF3	59709333697	11	A3A2Q3H5
59208929311	6	A3XF4	59859120193	13	A3DS4
59300796562	4	AL1A1S1	61259450100	6	A3A2
59306551514	6	A3S1	61450609078	1	W26
59306551514	6	A3S2	61450609083	1	W23
59309635956	7	A3S3	61450801819	1	W50
59309635957	5	A2S1	61451604775	1	W11
59309661651	7	A3S4	61451610913	1	W9
59351493427	7	A3A1J7	61451844325	1	W8
59351962234	2	A3W1P1	61452840866	1	W5
59351962234	7	A3P3	61455426092	1	W13
59352245984	3	AL1ALP2	61455480969	1	W15
59352245984	3	AL1ALP3	61455573591	1	W42
59352245984	3	AL1ALP4	61455773420	1	W12
59352245984	3	AL1ALP5	61455786824	1	W40
59352802195	2	W3MP1	61455786975	1	W45
59352802195	2	W3MP2	61455786978	1	W43
59352802195	2	A3W1MP1	61455819324	1	W41
59352802195	7	A3P3MP1	61456237224	1	W37
59353250989	1	A3W3P2	61456237225	1	W39
59354156070	8	A3J5	61456695551	1	W6
59356835281	2	W3P1	61456696710	1	W48
59356835281	2	W3P2	61456864916	1	W34
59356835281	4	AL1ALP1	61456864917	1	W33
59356859861	8	A3A3J2	61456864937	1	W21
59357553506	5	A2P1	61456864939	1	W19
59358350508	2	W2P1	61456864941	1	W17
59358350508	2	W2P2	61456864952	1	W30
59358360499	1	A3W3MP1	61456864954	1	W27
59358432844	6	A3J10	61456865274	1	W25
59358509157	2	A2P2	61457548057	1	W36
59358537596	6	A3J8	61457548058	1	W38
59358662255	6	A3W2P1	61458030663	1	W49
59359372162	2	W4P2	61458389444	1	W10
59359372162	11	A3A2J1		1	W24
59359596853	2	W4P1	61458413247	1	W28
59359596853	7	A3MP1J6	61459169561	1	W46
59402692219	6	A3J2	61459289896	1	W29
59402692219	6	A3J4	61459521735	1	W31
59403562493	6	A3J1	62108138265	6	A3XDS1
59403562493	6	A3J3	62108138265	6	A3XDS2
59405499610	7	A3A1TB3	62109904637	6	A3E1
59406448722	12	A3A2E7	62109904637	6	A3E2
59406448722	12	A3A2E8	62401557836	6	A3DS1
59406448722	8	A3A3E1	62401557836	6	A3DS2
59406448722	8	A3A3E2	66258717556	8	A3A3
59406448722	8	A3A3E3	66259034361	6	A3DS3
59406829416	12	A3A2E10	66259089578	2	A3W1
59406829416	12	A3A2E11	66259333526	1	A1
59406829416	12	A3A2E12	66259352567	2	W2
59407023517	5	A2E2	66259457937	2	A2
59408363536	11	A3A2E9	66259473413	2	W3
59408422917	9	A3TB1	66259473414	2	W4
59408422917	9	A3TB2	66259995119	1	1
59408422917	9	A3TB4	66259996080	6	A3
			66259999101	1	AL1A1

## SECTION III. INDEX-FEDERAL STOCK NUMBER AND REFERENCE NUMBER

## CROSS REFERENCE TO FIGURE AND ITEM NUMBER (CONTINUED)

REFERENCE CODE	MFG	FIG NO	ITEM NO	REFERENCE NO	MFG CODE	FIG NO	ITEM NO
AB396-1	12615	5	A2E2	MS35338-135	96906	5	A2MP15H2
ANARM93	80058	1	A3C6	MS35338-135	96906	5	A2MP19H2
A1444BRSHT	57771	8	A3A3MP1H1	MS35338-135	96906	12	A3A2A2H4
A16634	70674	12	A3A2L1	MS35338-135	96906	12	A3A2L1H3
CG2794U5FT	80058	2	W2	MS35338-135	96906	11	A3A2T1H2
CL33BJ100MNE	81349	11	A3A2C5	MS35338-135	96906	12	A3A2Q1H7
CL33BL020MNE	81349	8	A3C6	MS35338-135	96906	11	A3A2Q2H7
CM05ED200J03	81349	5	A2C3	MS35338-135	96906	11	A3A2Q3H7
CM05FD131J03	81349	5	A2C2	MS35338-137	96906	3	A1A1MP10H3
CM05FD241J03	81349	5	A2C4	MS35338-137	96906	3	A1A1MP11H2
CM05FD391J03	81349	8	A3A3C2	MS35338-97	96906	8	A3A3MP2H3
CM05FD391J03	81349	8	A3A3C4	MS35338-97	96906	8	A3A3E2H3
CM06FD102F03	81349	4	A1A1C1	MS35338-97	96906	8	A3A3E3H3
CM06FD182G03	81349	9	A3C1	MS35489-4	96906	7	A3A1MP5
CSR13G39SKL	81349	11	A3A2C6	MS35489-4	96906	9	A3MP8
CV2128ARN83	80058	6	A3A2	MS35489-6	96906	5	A2MP16
CW879ARM93	80058	1	A1	MS35649-224	96906	12	A3A2E7H1
CX11569ARM93	80058	2	A3W1	MS35649-224	96906	12	A3A2E8H1
CX11570ARM93	80058	2	W3	MS35649-224	96906	11	A3A2E9H1
CX11571ARM93	80058	2	W4	MS51957-1	96906	3	A1A1MP9H1
C6899ARN83	80058	1	A3A4	MS51957-1	96906	5	A2MP18H1
DF30BC	58474	6	A3J2	MS51957-1	96906	6	A3MP13H1
DF30BC	58474	6	A3J4	MS51957-12	96906	12	A3A2A1H2
DF30RC	58474	6	A3J1	MS51957-13	96906	3	A1A1MP6H1
DF30RC	58474	6	A3J3	MS51957-13	96906	8	A3A1R10H4
DM15C050D500VV4C	72136	5	A2C1	MS51957-13	96906	1	A3W3P2H1
DM15C100K500VV4C	72136	5	A2C1	MS51957-13	96906	12	A3A2A1H3
DM15C100K500VV4C	72136	5	A2C3	MS51957-13	96906	12	A3A2Q1H4
DM15C100K500VV4C	72136	5	A2C5	MS51957-13	96906	11	A3A2Q2H4
DM15C150K500VV4C	72136	5	A2C1	MS51957-13	96906	11	A3A2Q3H4
DM15C150K500VV4C	72136	5	A2C3	MS51957-14	96906	11	A3A2T1H1
DM15F431G300VV4C	72136	8	A3A3C1	MS51957-15	96906	7	A3A1J7H2
DM15F431G300VV4C	72136	8	A3A3C3	MS51957-15	96906	8	A3A1R10H5
DPX22017	71468	1	A3W3MP1	MS51957-16	96906	12	A3A2A2H2
DPX45-33S	71468	1	A3W3P2	MS51957-18	96906	5	A2MP15H1
F02A250V1AS	81349	6	A3F2	MS51957-18	96906	5	A2MP19H1
F02A250V1AS	81349	6	A3F4	MS51957-2	96906	5	A2E1H1
F02A250V3AS	81349	6	A3F1	MS51957-2	96906	5	A2E2H1
F02A250V3AS	81349	6	A3F3	MS51957-2	96906	12	A3A2E7H2
F12ACFMA2-62	72962	1	MP3MP2H3	MS51957-2	96906	12	A3A2E8H2
F12NCFMA2-62	72962	8	A3A3MP3H2	MS51957-27	96906	11	A3A2E9H2
F22NCFMA2-40	72962	8	A3A3MP3H1	MS51957-27	96906	6	A3H1
HKPH	71400	6	A3XF1	MS51957-27	96906	7	A3ALL11H1
HKPH	71400	6	A3XF2	MS51957-27	96906	9	A3MP14H1
HKPH	71400	6	A3XF3	MS51957-27	96906	8	A3A3H1
HKPH	71400	6	A3XF4	MS51957-29	96906	1	MP3MP1H2
HP10N	09922	7	A3A1MP4	MS51957-29	96906	1	MP3MP2H2
HP4N	09922	7	A3A1MP3	MS51957-29	96906	1	MP3MP4H2
LT4K093	81349	8	A3A3L1	MS51957-30	96906	7	A3A1MP3H2
LT4K093	81349	8	A3A3L5	MS51957-30	96906	7	A3A1MP4H2
LT4K093	81349	8	A3A3L6	MS51957-43	96906	3	A1A1MP11H1
LT4K093	81349	8	A3A3L9	MS51957-45	96906	3	A1A1MP10H1
MILWL16878TYPEB20	81349	1	W48	MS51959-14	96906	7	A3MP1H2
MILWL16878TYPEB20	81349	1	W49	MS51959-14	96906	7	A3A1H2
MMS-22SGDSS	95238	7	A3MP1J6	MS51959-15	96906	7	A3MP15H2
MMS-22SGDSS	95238	2	W4P1	MS51959-15	96906	7	A3MP16H2
MR3A11	11402	7	A3A1L11	MS91528-1P2B	96906	3	A1A1MP8
MS16535-53	96906	1	A1MP12H1	MS91528-3F2B	96906	6	A3MP10
MS16535-53	96906	1	A1MP13H1	MS91528-3F2B	96906	6	A3MP11
MS18130-21	96906	8	A3A3L2	MT3667ARM93	80058	1	A1A1
MS18130-21	96906	8	A3A3L4	MW375-140	08289	12	A3A2Q1H1
MS18130-21	96906	8	A3A3L7	MW375-140	08289	11	A3A2Q2H1
MS18130-21	96906	8	A3A3L8	MW375-140	08289	11	A3A2Q3H1
MS20426AD3-6	96906	1	MP3MP5H1	M39012-16-0001	81349	2	W2P1
MS21044D06	72962	1	MP3MP1H1	M39012-16-0001	81349	2	W2P2
MS21044D06	96906	1	MP3MP2H1	NAS671C4	80205	7	A3MP1H1
MS21044D06	96906	1	MP3MP4H1	NAS671C4	80205	7	A3A1H1
MS25237-327	96906	6	A3DS1	NAS671C4	80205	7	A3A1J7H1
MS25237-327	96906	6	A3DS2	NAS671C4	80205	7	A3MP15H1
MS27183-1	96906	6	A3J10H1	NAS671C4	80205	7	A3MP16H1
MS3057-6	96906	2	W3MP1	NAS671C4	80205	12	A3A2L1H1
MS3057-6	96906	2	W3MP2	NAS671C4	80205	12	A3A2Q1H3
MS3057-6A	96906	7	A3P3MP1	NAS671C4	80205	11	A3A2Q2H3
MS3102A14S5P	96906	7	A3A1J7	NAS671C4	80205	11	A3A2Q3H3
MS3106A14S5S	96906	2	A3W1P1	ND29143-024	65092	8	A3A3MP2H2
MS3106A14S5S	96906	7	A3P3	PT02A12-10P	77820	8	A3A3J2
MS35057-6	96906	2	A3W1MP1	PT06A10-6S	77820	5	A2P1
MS35170-260D	96906	2	A2P2	PT06A12-10S	77820	2	A1A1P1
MS35214-12	96906	8	A3A3J2H1	PT06A12-10S	77820	4	W3P1
MS35214-30	96906	6	A3DS3H2	PT06A12-10S	77820	2	W3P2
MS35214-30	96906	6	A3DS4H2	PT06A20-41SSR	77820	6	A3W2P1
MS35333-70	96906	7	A3MP1H3	P015-0558-000	77250	8	A3A1R10H3
MS35333-70	96906	7	A3A1H3	P313-0045-000	77250	4	A1A1P2H1
MS35333-70	96906	7	A3A1J7H3	P313-0045-000	77250	4	A1A1P3H1
MS35333-70	96906	8	A3A1R10H7	P313-0045-000	77250	4	A1A1P4H1
MS35333-70	96906	1	A3W3P2H2	P313-0045-000	77250	4	A1A1P5H1
MS35333-70	96906	7	A3MP15H3	P313-0045-000	77250	6	A3DS3H1
MS35333-70	96906	7	A3MP16H3	P313-0045-000	77250	6	A3DS4H1
MS35333-71	96906	7	A3A1L11H2	P313-0051-000	77250	8	A3A3E1H1
MS35333-71	96906	9	A3MP14H2	P313-0051-000	77250	8	A3A3E2H1
MS35333-71	96906	6	A3DS3H3	P313-0062-000	77250	8	A3A3E3H1
MS35333-71	96906	6	A3DS4H3	P313-0062-000	77250	5	A2S1H1
MS35338-134	96906	5	A2E1H2	P313-0062-000	77250	8	A3A1R8H1
MS35338-134	96906	5	A2E2H2	P313-0062-000	77250	8	A3J5H1
MS35338-134	96906	12	A3A2E7H3	P313-0062-000	77250	7	A3S4H1
MS35338-134	96906	12	A3A2E8H3	P330-2290-000	77250	12	A3A2L1H2
MS35338-134	96906	11	A3A2E9H3	P334-0287-00	77250	11	A3A2R1H1
MS35338-135	96906	3	A1A1MP6H3	P343-0284-000	77250	8	A3A3MP2H1

## SECTION III. INDEX-FEDERAL STOCK NUMBER AND REFERENCE NUMBER

## CROSS REFERENCE TO FIGURE AND ITEM NUMBER (CONTINUED)

REFERENCE CODE	MFG	FIG NO	ITEM NO	REFERENCE NO	MFG CODE	FIG NO	ITEM NO
P343-0285-000	77250	8	A3A3E1H2	100122	24363	13	A3DS4MPI9MP16
P343-0285-000	77250	8	A3A3E2H2	100123	24363	10	A3DS3MP9
P343-0285-000	77250	8	A3A3E3H2	100123	24363	13	A3DS4MP8
P343-0386-000	77250	7	A3A1TB3H1	100124	24363	10	A3DS3MP8
QQW343TYPESAWG24	90484	1	W12	100125	24363	13	A3DS4MP9
RA24705	71450	8	A3A1R8	100126	24363	13	A3DS4MP5
RCR07G331KS	81349	12	A3A2R2	100126	24363	10	A3DS3MP7
RCR07G682KS	81349	7	A3A1R6	100127	24363	13	A3DS4MP10
RCR07G821KS	81349	12	A3A2R4	100129	24363	13	A3DS4MP20
RCR07G821KS	81349	12	A3A2R5	100129	24363	10	A3DS3MP19
RCR20G182KS	81349	12	A3A2R6	100130	24363	13	A3DS4MP21
RCR20G271KS	81349	7	A3A1R7	100131	24363	10	A3DS3MP11
RCR20G470KS	81349	12	A3A2R3	100132-1	24363	13	A3DS4MP28
RG58CU	80058	1	W13	100134	24363	13	A3DS4MP27
RG62AU	80058	1	W9	100135	24363	13	A3DS4MP6
RG62BU	80058	1	W7	100141	24363	13	A3DS4MP4
RL32S510J	81349	9	A3R1	108-750-1	74970	3	A1A1P2
RN60D1001F	81349	9	A3R3	108-750-1	74970	3	A1A1P3
RN60D4221F	81349	9	A3R4	108-750-1	74970	3	A1A1P4
RN60D4221F	81349	9	A3R5	108-750-1	74970	3	A1AP5
RN60D5113F	81349	7	A3A1R9	110102-2	24363	10	A3DS3MP15H17
RN65D9090F	81349	9	A3R2	110102-2	24363	13	A3DS4MP20H23
RW29V161	81349	8	A3A1R10	110104-4	24363	10	A3DS3J1H12
R22NCFM1-40	72962	12	A3A2A1H1	110104-4	24363	10	A3DS3MP1H2
SL347-322WHT	12615	12	A3A2E13	110104-4	24363	13	A3DS4MP19H18
SL347-322WHT	12615	12	A3A2E14	1181	06481	7	A3A1TB3
SL388-351WHT	12615	12	A3A2E1	1203-00	78189	7	A3A1TB3H2
SL388-351WHT	12615	12	A3A2E2	1400W	72512	5	A2MP1
SL388-351WHT	12615	12	A3A2E3	150D105X0035A2	56289	12	A3A2C8
SL388-351WHT	12615	12	A3A2E4	150D105X0035A2	56289	12	A3A2C9
SL388-351WHT	12615	12	A3A2E5	150D106X0020B2	56289	11	A3A2C6
SL388-351WHT	12615	12	A3A2E6	150D225X0020A2	56289	11	A3A2C6
SM446ARM93	80058	2	A2	150D335X0015A2	56289	11	A3A2C2
TA2402A	08289	12	A3A2Q1H2	150D335X0015A2	56289	11	A3A2C6
TA2402A	08289	11	A3A2Q2H2	150D475X0035B2	56289	11	A3A2C1
TA2402A	08289	11	A3A2Q3H2	150D475X0035B2	56289	11	A3A2C3
TF300	98291	5	A2E1	150D475X0035B2	56289	11	A3A2C4
TS2502ARM93	80058	6	A3	150D475X0035B2	56289	11	A3A2C6
TW135-175-40	08289	12	A3A2Q1H5	150D685X0035B2	56289	11	A3A2C6
TW135-175-40	08289	11	A3A2Q2H5	1542A	71785	9	A3TB1
TW135-175-40	08289	11	A3A2Q3H5	1542A	71785	9	A3TB2
UG1094U	80058	6	A3J8	162-0931	71785	9	A3TB4
UG910BU	80058	6	A3J10	162-0931	72619	6	A3E1
WTE22A	90484	1	W14	162-8430-09-502	72619	6	A3E2
021-0381-020	74284	1	A1MP4	162-8430-09-502	72619	6	A3XDS1
021-0381-030	74284	1	MP3MP3	1714-05	72619	6	A3XDS2
1XT22730-0	12515	1	W36	1720-02	78189	11	A3A2R1H2
1XT22730-03	12515	1	W44	1720-02	78189	5	A2S1H2
1XT22730-1	12515	1	W41	1720-02	78189	8	A3A1R8H2
1XT22730-2	12515	1	W37	1720-02	78189	8	A3J5H2
1XT22730-3	12515	1	W38	200101	78189	7	A3S4H2
1XT22730-4	12515	1	W42	200121	24363	6	A3DS3
1XT22730-5	12515	1	W39	210102-2	24363	10	A3DS3MP1
1XT22730-6	12515	1	W40	210102-2	24363	10	A3DS3MP15H18
1XT22730-7	12515	1	W45	210104-4	24363	13	ADDS4MP20H22
1XT22730-8	12515	1	W43	210104-4	24363	10	A3DS3J1H13
1XT22730-9	12515	1	W15	210104-4	24363	10	A3DS3MP1H3
1XT22730-90	12515	1	W16	2104-04-01-2520N	24363	13	A3DS4MP19H17
1XT22730-902	12515	1	W22	2104-04-01-2520N	78189	8	A3A1E1
1XT22730-903	12515	1	W23	212-12N	78189	7	A3E3
1XT22730-905	12515	1	W24	22499-67381-4	71286	1	MP3MP5
1XT22730-906	12515	1	W25	22499-673B1-4	92607	1	W51
1XT22730-906	12515	1	W17	22499-673B1-5	92607	1	W50
1XT22730-912	12515	1	W26	236924A1	76854	5	A2S1
1XT22730-912	12515	1	W27	259-2312-220	81349	7	A3S3
1XT22730-913	12515	1	W28	26S13B6	71286	1	MP3MP4H4
1XT22730-915	12515	1	W29	2600LW	71286	1	MP3MP4H3
1XT22730-916	12515	1	W18	28235-728LR4	82104	7	A3S4
1XT22730-92	12515	1	W30	300101	24363	13	A3DS4
1XT22730-923	12515	1	W31	300121	24363	13	A3DS4MP19
1XT22730-925	12515	1	W32	302-0347-000	91500	8	A3A1R10H1
1XT22730-926	12515	1	W19	302-2300-000	16037	8	A3A1R10H2
1XT22730-935	12515	1	W33	310-0045-000	79807	12	A3A2Q1H6
1XT22730-9356	12515	1	W35	310-0045-000	79807	11	A3A2Q2H6
1XT22730-936	12515	1	W34	310-0046-000	79807	11	A3A2Q3H6
1XT22730-95	12515	1	W20	310-0046-000	79807	6	A3H2
1XT22730-95	12515	1	W21	310-0046-000	79807	7	A3A1MP4H3
10-123017-10-3	77820	4	A1A1P1H2	310-0048-000	79807	3	A1A1MP10H2
100102-2	24363	10	A3DS3MP15	310-0076-000	79807	8	A3A3E1H3
100103-1	24363	10	A3DS3MP5	310-0077-000	79807	4	A1A1P2H2
100103-2	24363	13	A3DS4MP15	310-0077-000	79807	4	A1A1P3H2
100104	24363	13	ADS4MP25	310-0077-000	79807	4	A1A1P4H2
100105	24363	10	A3DS3J1	310-0077-000	79807	4	A1A1P5H2
100106	24363	10	A3DS3J1MP14	310-6340-000	79807	3	A1A1MP6H2
100107	24363	13	A3DS4MP12	310-6360-000	79807	1	MP3MP1H3
100108-1	24363	13	A3DS4MP10H13	334-0890-00	21537	5	A2P1H1
100108-2	24363	13	A3DS4MP1H2	340-0644-000	91314	12	A3A2A2H3
100109	24363	13	A3DS4MP14	380-1583-000	75818	1	W5
100110	24363	13	A3DS4MP6	38164	01121	11	A3A2R1
100113	24363	13	A3DS4MP1	39179	73386	11	A3A2T1
10014	24363	13	A3DS4MP1H3	39179	02735	12	A3A2Q1
100116	24363	10	A3DS3MP10	39179	02735	11	A3A2Q2
10016	24363	13	A3DS4MP7	39179	02735	11	A3A2Q3
100118	24363	10	A3DS3MP6	4-03649-0210	70674	7	A3J5
100118	24363	13	A3DS3MP16	4JX11B2023	03508	8	A3A1Q1
100120-2	24363	10	A3DS3MP16	4007-4HT	77147	12	A3A2E7
100120-3	24363	13	A3DS4MP24	4007-4HT	77147	12	A3A2E8
100122	24363	10	A3DS3MP1MP4	4007-4HT	77147	8	A3A3E1



## SECTION III. INDEX-FEDERAL STOCK NUMBER AND REFERENCE NUMBER

## CROSS REFERENCE TO FIGURE AND ITEM NUMBER (CONTINUED)

REFERENCE CODE	MFG	FIG NO	ITEM NO	REFERENCE NO	MFG CODE	FIG NO	ITEM NO
		8	A3A3E2	762-1557-001	13499	7	A3A1MP2
4007-4HT	77147	8	A3A3E3	762-1560-002	13499	7	A3MP1MP1
4007-4HT	77147	11	A3A2E9	762-1560-003	13499	7	A3MP1
4040-2HDSPL	77147	12	A3A2E10	762-1563-002	13499	6	A3MP12
4040-5HDSPL	77147	12	A3A2E11	762-1563-002	13499	1	MP3MP1
4040-5HDSPL	77147	12	A3A2E12	762-1565-002	13499	1	MP3MP4
4040-5HDSPL	77147	1	W10	762-1567-002	13499	6	A3MP7
421-0074-000	94130	1	W11	762-1667-003	13499	6	A3MP15
421-2220-000	94130	1	W46	762-1667-004	13499	5	A2MP14
439-5275-000	05973	1	W47	762-1679-001	13499	3	A1A1MP11
439-5277-000	05973	4	A1A1S1	762-1679-002	13499	3	A1A1MP10
44A30-02-1-2N	81073	2	W3MP1H1	762-1680-001	13499	4	A1A1P1H1
496CDPL	01181	2	W3MP2H1	762-1702-001	13499	1	A1MP5
496CDPL	01181	8	A3A1R10H6	762-1703-001	13499	7	A3A1
504-0730-003	13499	1	W6	762-1709-001	13499	7	A3MP6
5064	70903	5	A2MP19	762-1710-001	13499	6	A3W2
540-9053-003	13499	9	A3MP14	762-1736-001	13499	1	A1MP12
540-9221-003	13499	8	A3A3MP3	762-1736-002	13499	5	A2MP18
549-6436-003	13499	8	A3A3MP2	762-1736-003	13499	3	A1A1MP9
549-6444-003	13499	8	A3A3MP1	762-1737-001	13499	6	A3MP13
549-6450-004	13499	8	A3A3L3	762-1738-001	13499	1	A1MP13
549-6541-003	13499	8	A3A3L10	762-1774-001	13499	8	A3A3
549-6541-003	13499	7	A3A1MP3H1	762-1775-001	13499	6	A3MP7H3
68NM62	72962	7	A3A1MP4H1	763-6272-001	13499	12	A3A2A2
68NM62	72962	2	W4P2	767-8168-001	13499	12	A3A2A1
7030-5P1004	03877	11	A3A2J1	768-1151-001	13499	12	A3A2A2H1
7030-5P1004	03877	1	A3W3	82980S	04009	6	A3S1
762-1498-001	13499	4	A1A1MP7	82980S	04009	6	A3S2
762-1499-001	13499	4	A1A1MP6	8422	70903	1	W8
762-1499-002	13499	1	MP3MP2	905	75543	9	A3MP9
762-1553-003	13499	1	MP3	9722-18-00-0243	02768	6	A3MP7H2
762-1555-001	13499	7	A3MP15	98-2CP	78189	6	A3MP7H1
762-1556-001	13499	7	A3MP16				
762-1556-001	13499						

SECTION IV. INDEX-REFERENCE DESIGNATION CROSS-REFERENCE TO PAGE NUMBER

REFERENCE DESIGNATION	PAGE NO	REFERENCE DESIGNATION	PAGE NO	REFERENCE DESIGNATION	PAGE NO
A1	1	A3A1H3	11	A3A2E9M1	14
A1A1	1	A3A1J7	11	A3A2E9M2	14
A1A1C1	1	A3A1J7M1	11	A3A2E9M3	14
A1A1MP10	1	A3A1J7M2	11	A3A2J1	14
A1A1MP10H1	1	A3A1J7M3	11	A3A2L1	14
A1A1MP10H2	1	A3A1L11	11	A3A2L1M1	14
A1A1MP10H3	1	A3A1L11M1	11	A3A2L1M2	14
A1A1MP11	1	A3A1L11M2	11	A3A2L1M3	14
A1A1MP11H1	1	A3A1MP2	11	A3A2Q1	14
A1A1MP11H2	1	A3A1MP3	11	A3A2Q1M1	14
A1A1MP6	1	A3A1MP3H1	11	A3A2Q1M2	14
A1A1MP6H1	1	A3A1MP3H2	11	A3A2Q1M3	14
A1A1MP6H2	1	A3A1MP4	11	A3A2Q1M4	14
A1A1MP6H3	1	A3A1MP4H1	11	A3A2Q1M5	14
A1A1MP7	1	A3A1MP4M2	11	A3A2Q1M6	14
A1A1MP8	1	A3A1MP4H3	11	A3A2Q1M7	14
A1A1MP9	1	A3A1MP5	11	A3A2Q2	14
A1A1MP9H1	1	A3A1Q1	11	A3A2Q2M1	14
A1A1P1	1	A3A1R10	11	A3A2Q2M2	14
A1A1P1H1	1	A3A1R10H1	11	A3A2Q2M3	14
A1A1P1H2	1	A3A1R10H2	11	A3A2Q2M4	14
A1A1P2	1	A3A1R10H3	11	A3A2Q2M5	14
A1A1P2H1	1	A3A1R10H4	11	A3A2Q2M6	14
A1A1P2H2	1	A3A1R10H5	11	A3A2Q2M7	14
A1A1P3	1	A3A1R10H6	11	A3A2Q3	14
A1A1P3H1	1	A3A1R10H6	11	A3A2Q3M1	14
A1A1P3H2	1	A3A1R10H7	11	A3A2Q3M2	14
A1A1P4	1	A3A1R6	11	A3A2Q3M3	14
A1A1P4H1	1	A3A1R7	11	A3A2Q3H4	14
A1A1P4H2	1	A3A1R8	11	A3A2Q3H5	14
A1A1P5	1	A3A1R9	11	A3A2Q3H6	14
A1A1P5H1	1	A3A1Te3	11	A3A2Q3H7	14
A1A1P5H2	1	A3A1Te3H1	11	A3A2Q4	14
A1A1P6	1	A3A1Te3H1	11	A3A2Q4M1	14
A1A1P7	1	A3A1Te3H2	11	A3A2Q4M2	14
A1MP12	1	A3A2	11	A3A2R2	14
A1MP12H1	1	A3A2A1	11	A3A2R3	14
A1MP13	1	A3A2A1M1	11	A3A2R4	14
A1MP13H1	1	A3A2A1M2	11	A3A2R5	14
A1MP4	1	A3A2A1M3	11	A3A2R6	14
A1MP5	1	A3A2A2	11	A3A2T1	14
A2	1	A3A2A2M1	11	A3A2T1M1	14
A2C1	1	A3A2A2M2	11	A3A2T1M2	14
A2C1	1	A3A2A2M3	11	A3A3	14
A2C1	1	A3A2A2M4	11	A3A3C1	14
A2C2	1	A3A2C1	11	A3A3C2	14
A2C3	1	A3A2C2	11	A3A3C3	14
A2C3	1	A3A2C3	11	A3A3C4	14
A2C4	1	A3A2C4	11	A3A3E1	14
A2C5	1	A3A2C5	11	A3A3E1M1	14
A2E1	1	A3A2C6	11	A3A3E1M2	14
A2E1H1	1	A3A2C6	11	A3A3E1M3	14
A2E1H2	1	A3A2C6	11	A3A3E2	14
A2E2	1	A3A2C6	11	A3A3E2M1	14
A2E2H1	1	A3A2C6	11	A3A3E2M2	14
A2E2H2	1	A3A2C6	11	A3A3E2M3	14
A2MP1	1	A3A2C6	11	A3A3E3	14
A2MP14	1	A3A2C9	11	A3A3E3M1	14
A2MP15	1	A3A2E1	11	A3A3E3M2	14
A2MP15M1	1	A3A2E1M	11	A3A3E3M3	14
A2MP15M2	1	A3A2E11	11	A3A3H1	14
A2MP16	1	A3A2E12	11	A3A3J2	14
A2MP16	1	A3A2E13	11	A3A3J2M1	14
A2MP16H1	1	A3A2E14	11	A3A3L1	14
A2MP17	1	A3A2E2	11	A3A3L1M	14
A2MP17H1	1	A3A2E3	11	A3A3L2	14
A2MP17H2	1	A3A2E4	11	A3A3L3	14
A2P1	1	A3A2E5	11	A3A3L4	14
A2P1H1	1	A3A2E6	11	A3A3L5	14
A2P2	1	A3A2E7	11	A3A3L6	14
A2P1	1	A3A2E7M1	11	A3A3L7	14
A2P1H1	1	A3A2E7M2	11	A3A3L8	14
A2P1H2	1	A3A2E7M3	11	A3A3L9	14
A3	1	A3A2E8	11	A3A3MP1	14
A3A1	1	A3A2E8M1	11	A3A3MP1H1	14
A3A1C1	1	A3A2E8M2	11	A3A3MP2	14
A3A1M1	1	A3A2E8M3	11	A3A3MP2M1	14
A3A1M2	1	A3A2E9	11	A3A3MP2H2	14

SECTION IV. INDEX-REFERENCE DESIGNATION CROSS-REFERENCE TO PAGE NUMBER (CONTINUED)

REFERENCE DESIGNATION	PAGE NO	REFERENCE DESIGNATION	PAGE NO	REFERENCE DESIGNATION	PAGE NO
A3A3MP2H3	10	A3J1	14	MP3MP1H2	14
A3A3MP3	10	A3J10	14	MP3MP1H3	14
A3A3MP4H1	10	A3J10H1	14	MP3MP2	14
A3A3MP3H2	10	A3J2	14	MP3MP2H1	14
A3A4	10	A3J3	14	MP3MP2H2	14
A3C1	10	A3J4	14	MP3MP2H3	14
A3C6	10	A3J5	14	MP3MP3	14
A3D31	10	A3J5H1	14	MP3MP4	14
A3D32	10	A3J5H2	14	MP3MP4H1	14
A3D33	10	A3J6	14	MP3MP4H2	14
A3D33H1	10	A3MP1	14	MP3MP4H3	14
A3D33H2	10	A3MP1H1	14	MP3MP4H4	14
A3D33H3	10	A3MP1H2	14	MP3MP5	14
A3D33J1	10	A3MP1H3	14	MP3MP5H1	14
A3D33J1H12	10	A3MP1J6	14	W10	14
A3D33J1H13	10	A3MP1NP1	14	W11	14
A3D33J1MP14	10	A3MP1L	14	W12	14
A3D33MP1	10	A3MP11	14	W13	14
A3D33MP1H2	10	A3MP12	14	W14	14
A3D33MP1H3	10	A3MP13	14	W15	14
A3D33MP1MP4	10	A3MP13H1	14	W16	14
A3D33MP1U	10	A3MP14	14	W17	14
A3D33MP11	10	A3MP14H1	14	W18	14
A3D33MP15	10	A3MP14H2	14	W19	14
A3D33MP15H16	10	A3MP15	14	W2	14
A3D33MP15H17	10	A3MP15H1	14	W2P1	14
A3D33MP16	10	A3MP15H2	14	W2P2	14
A3D33MP19	10	A3MP15H3	14	W2U	14
A3D33MP5	10	A3MP16	14	W21	14
A3D33MP6	10	A3MP16H1	14	W22	14
A3D33MP7	10	A3MP16H2	14	W23	14
A3D33MP8	10	A3MP16H3	14	W24	14
A3D33MP9	10	A3MP20	14	W25	14
A3D34	21	A3MP7	14	W26	14
A3D34H1	21	A3MP7H1	14	W27	14
A3D34H2	21	A3MP7H2	14	W28	14
A3D34H3	21	A3MP7H3	14	W29	14
A3D34MP1	22	A3MP8	14	W3	14
A3D34MP1H2	22	A3MP9	14	A3MP1	14
A3D34MP1H3	22	A3P3	14	A3MP1H1	14
A3D34MP1U	22	A3P3MP1	14	A3MP2	14
A3D34MP1UH13	22	A3R1	14	A3MP2H1	14
A3D34MP11	22	A3R2	14	W3P1	14
A3D34MP12	22	A3R3	14	W3P2	14
A3D34MP14	22	A3R4	14	W3U	14
A3D34MP15	22	A3R5	14	W31	14
A3D34MP19	22	A3S1	14	W32	14
A3D34MP19H17	22	A3S2	14	W33	14
A3D34MP19H16	22	A3S3	14	W34	14
A3D34MP19MP16	22	A3S4	14	W35	14
A3D34MP2U	21	A3S4H1	14	W36	14
A3D34MP2UH23	21	A3S4H2	14	W37	14
A3D34MP2UH2C	21	A3T61	14	W38	14
A3D34MP21	21	A3T62	14	W39	14
A3D34MP24	22	A3T64	14	W4	14
A3D34MP25	21	A3W1	14	W4P1	14
A3D34MP26	21	A3W1MP1	14	W4P2	14
A3D34MP27	22	A3W1P1	14	W4U	14
A3D34MP28	22	A3W2	14	W41	14
A3D34MP4	21	A3W2P1	14	W42	14
A3D34MP5	22	A3W3	14	W43	14
A3D34MP6	21	A3A3MP1	14	W44	14
A3D34MP7	22	A3A3P2	14	W45	14
A3D34MP8	21	A3A3P2H1	14	W46	14
A3D34MP9	22	A3A3P2H2	14	W47	14
A3E1	13	A3X0S1	14	W48	14
A3E2	13	A3X0S2	14	W49	14
A3E3	13	A3XF1	14	W5	14
A3F1	13	A3XF2	14	W5U	14
A3F2	13	A3XF3	14	W51	14
A3F3	13	A3XF4	14	W6	14
A3F4	13	MP3	14	W7	14
A3H1	10	MP3MP1	14	W8	14
A3H2	10	MP3MP1H1	14	W9	14
				1	



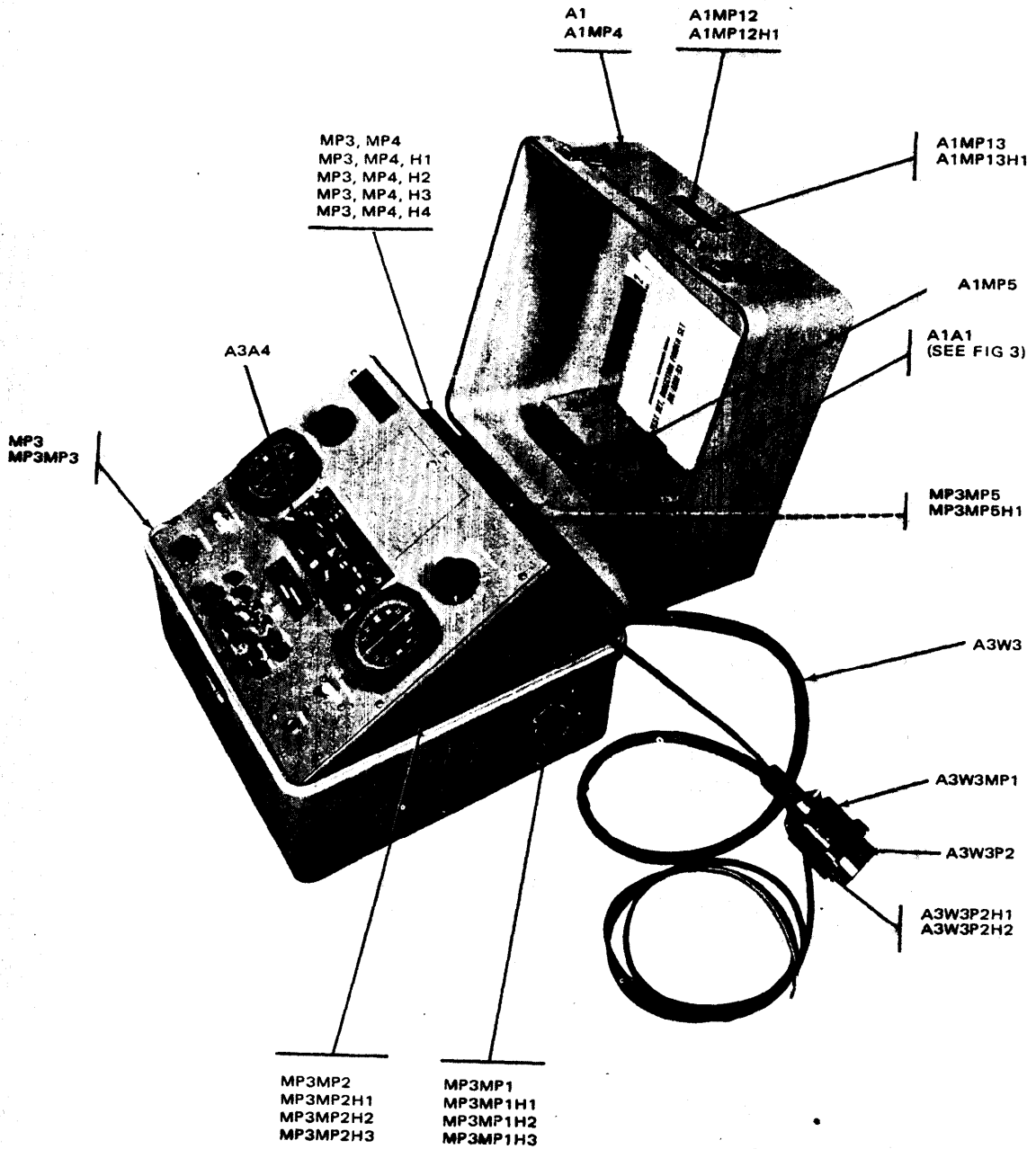

ASSEMBLY 1 FIGURE 1

EL6625-821-40P-1

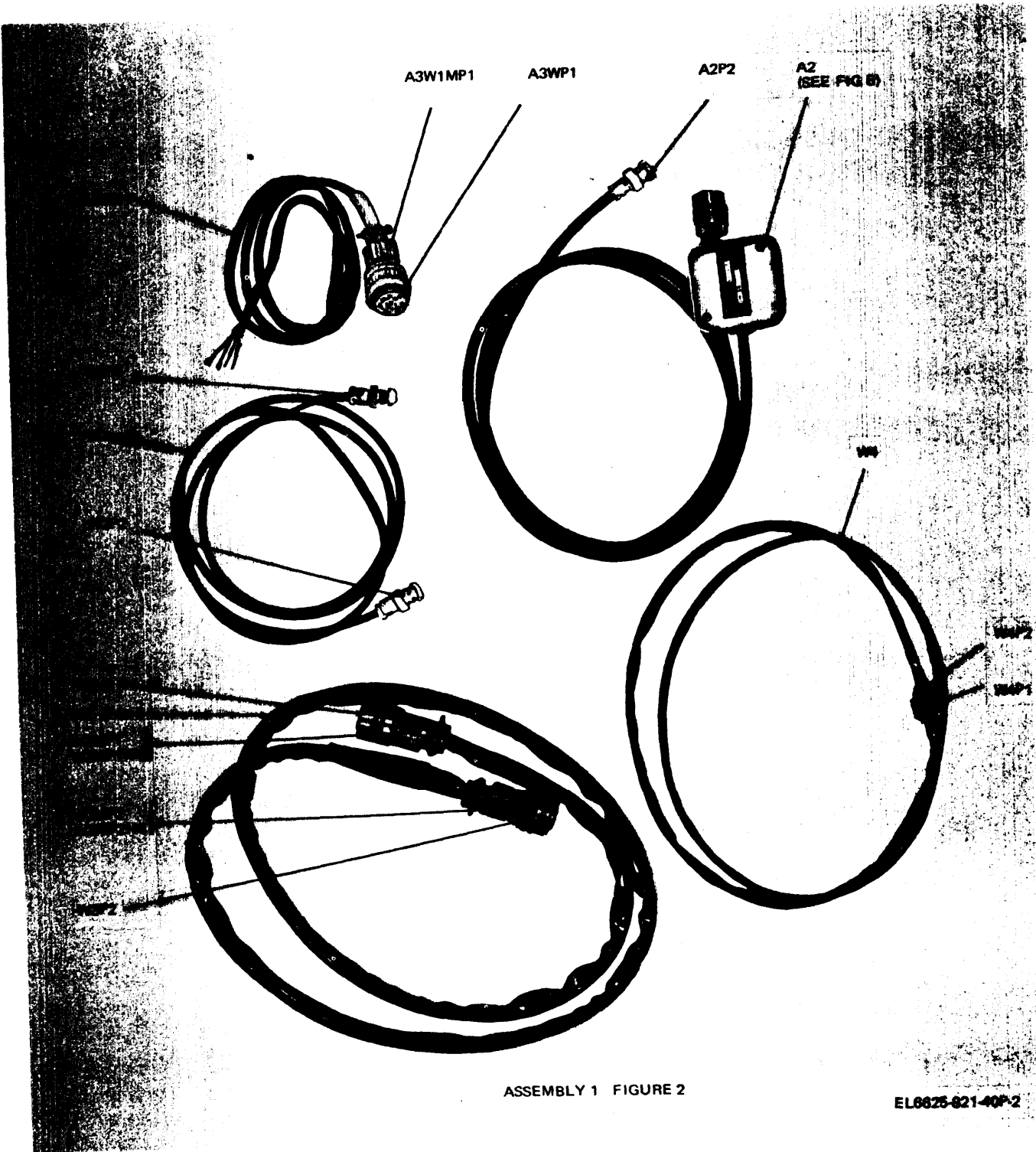

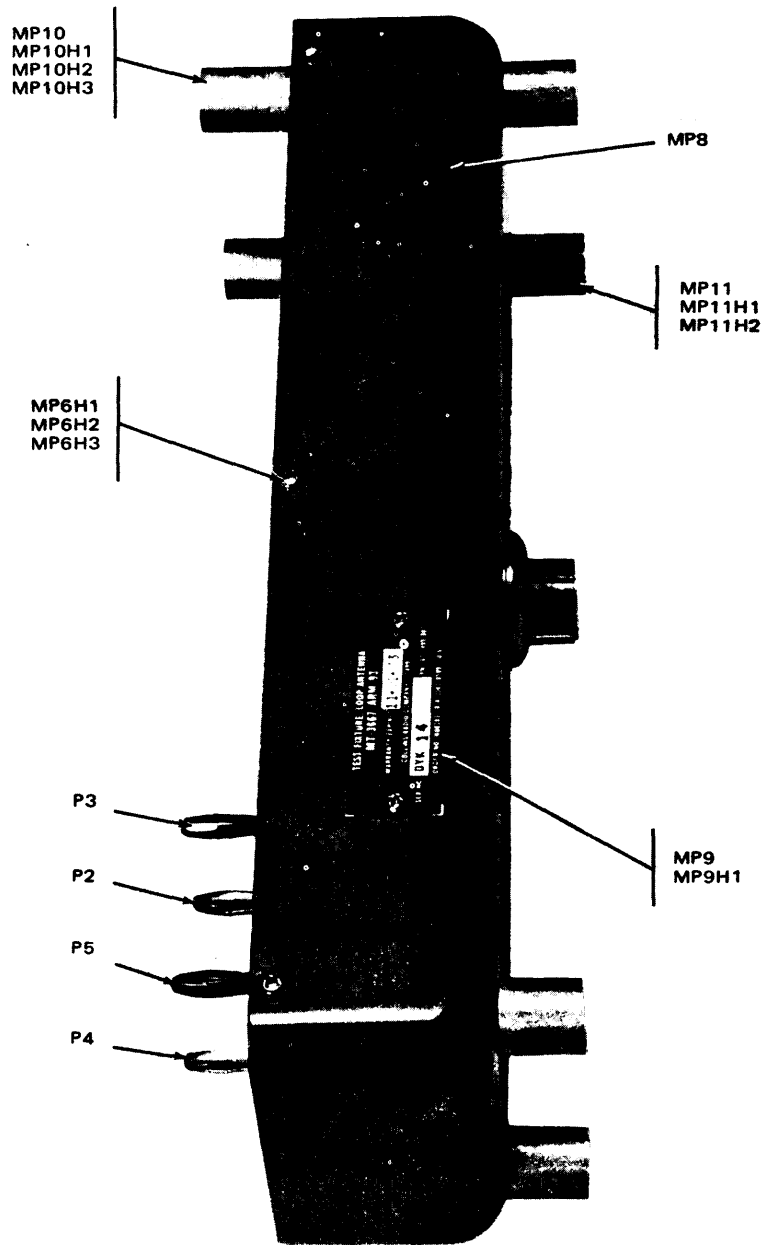

ASSEMBLY A1A1 FIGURE 3

EL6625-821-40P-3

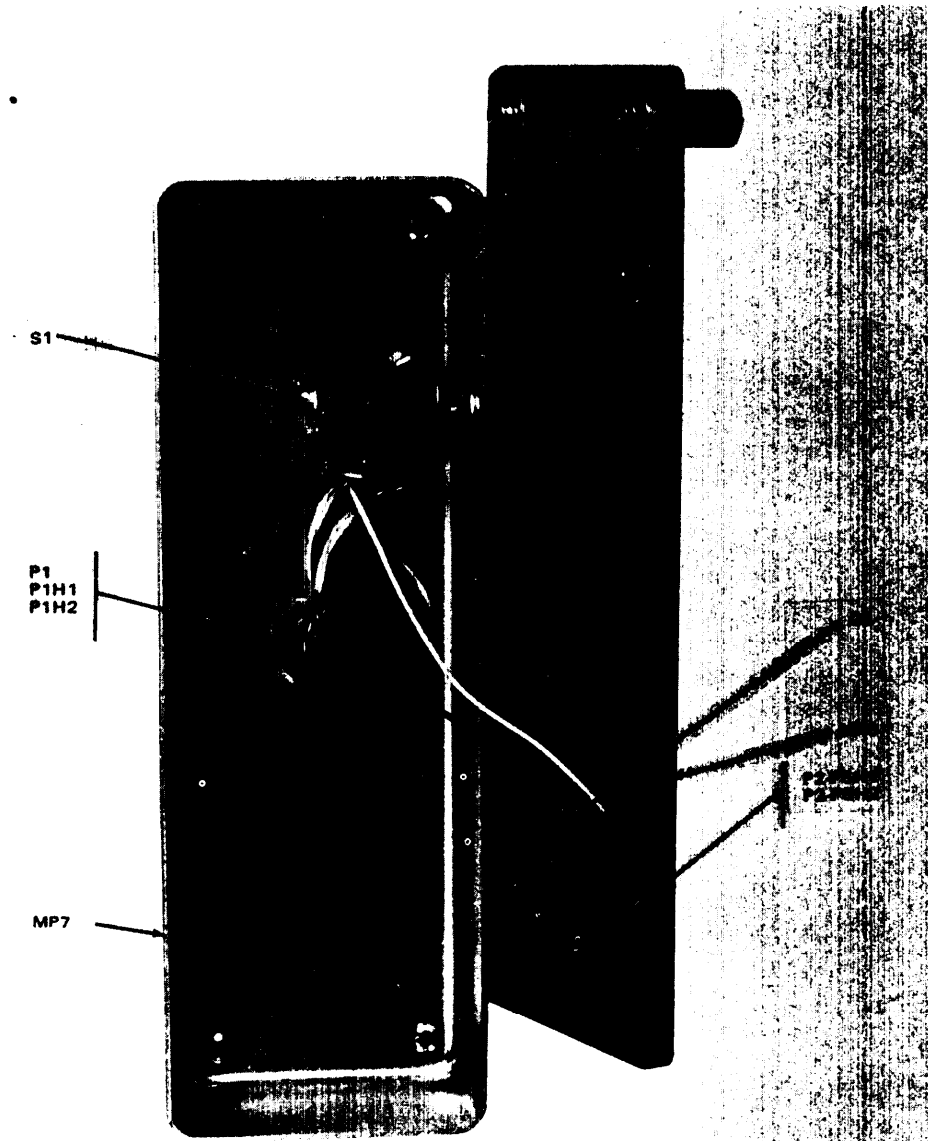

ASSEMBLY A1A1 FIGURE 4

EL6625-621-40P-4



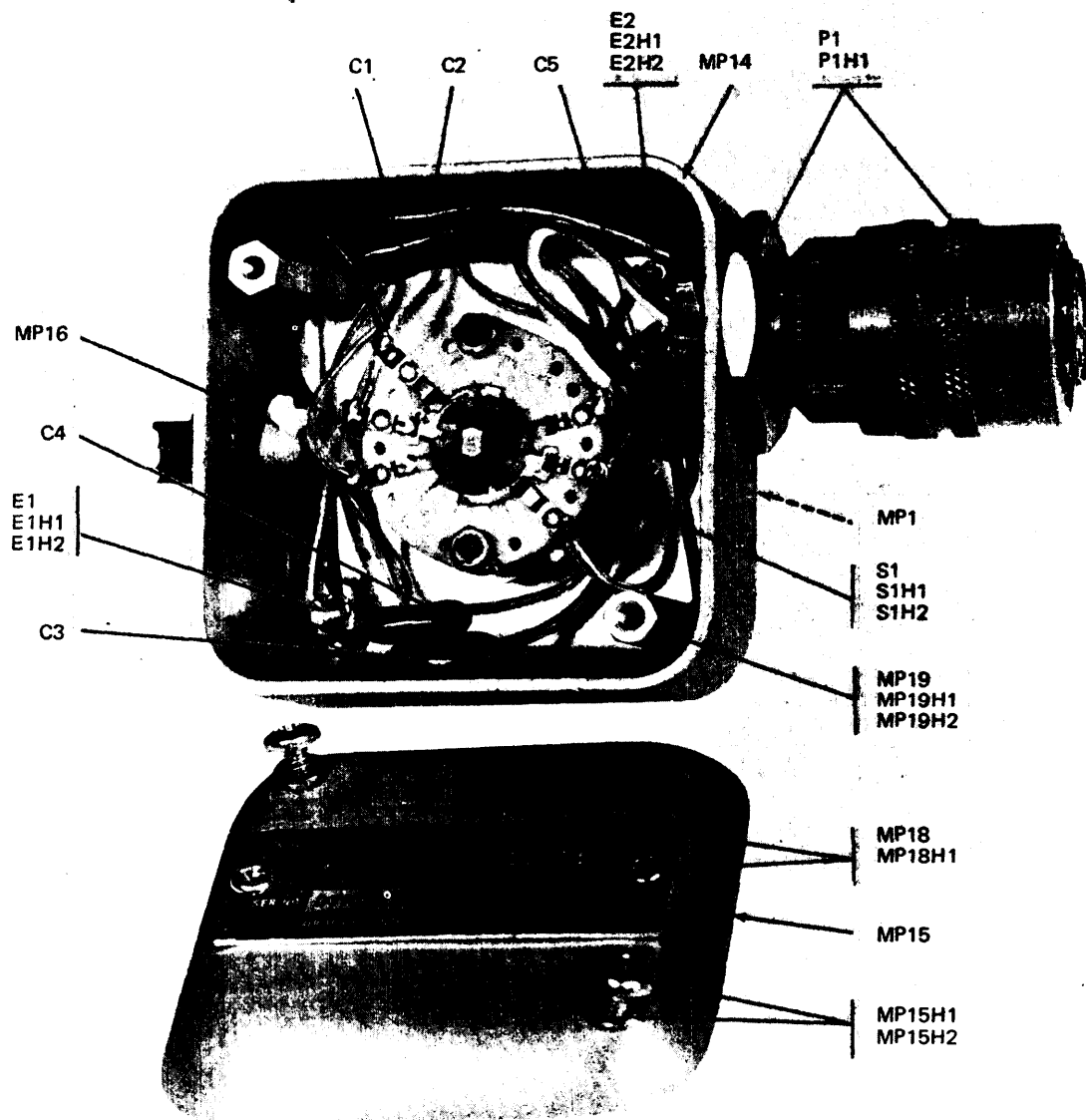

ASSEMBLY A2 FIGURE 5

EL6625-821-40P-5

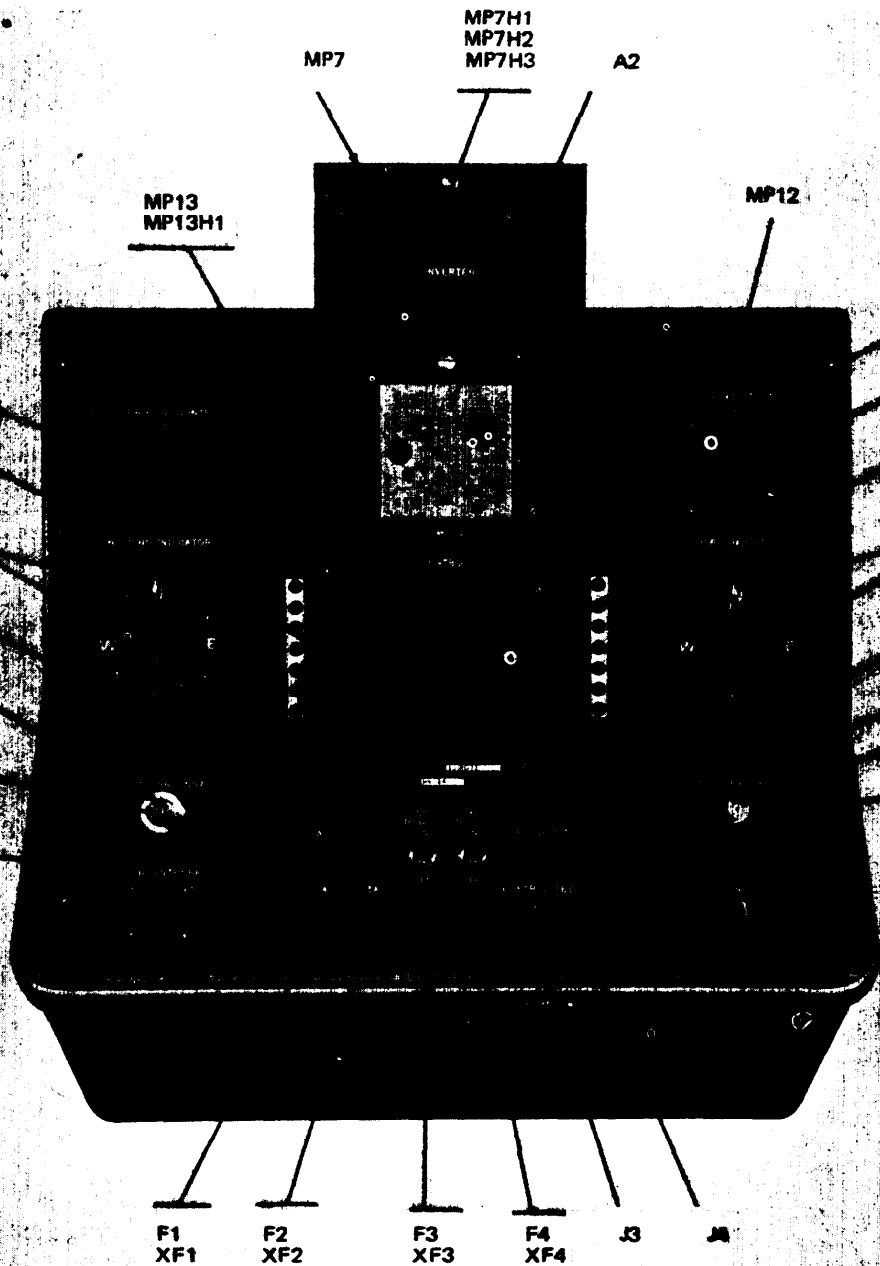

ASSEMBLY A3 FIGURE 6

ELECTRONIC

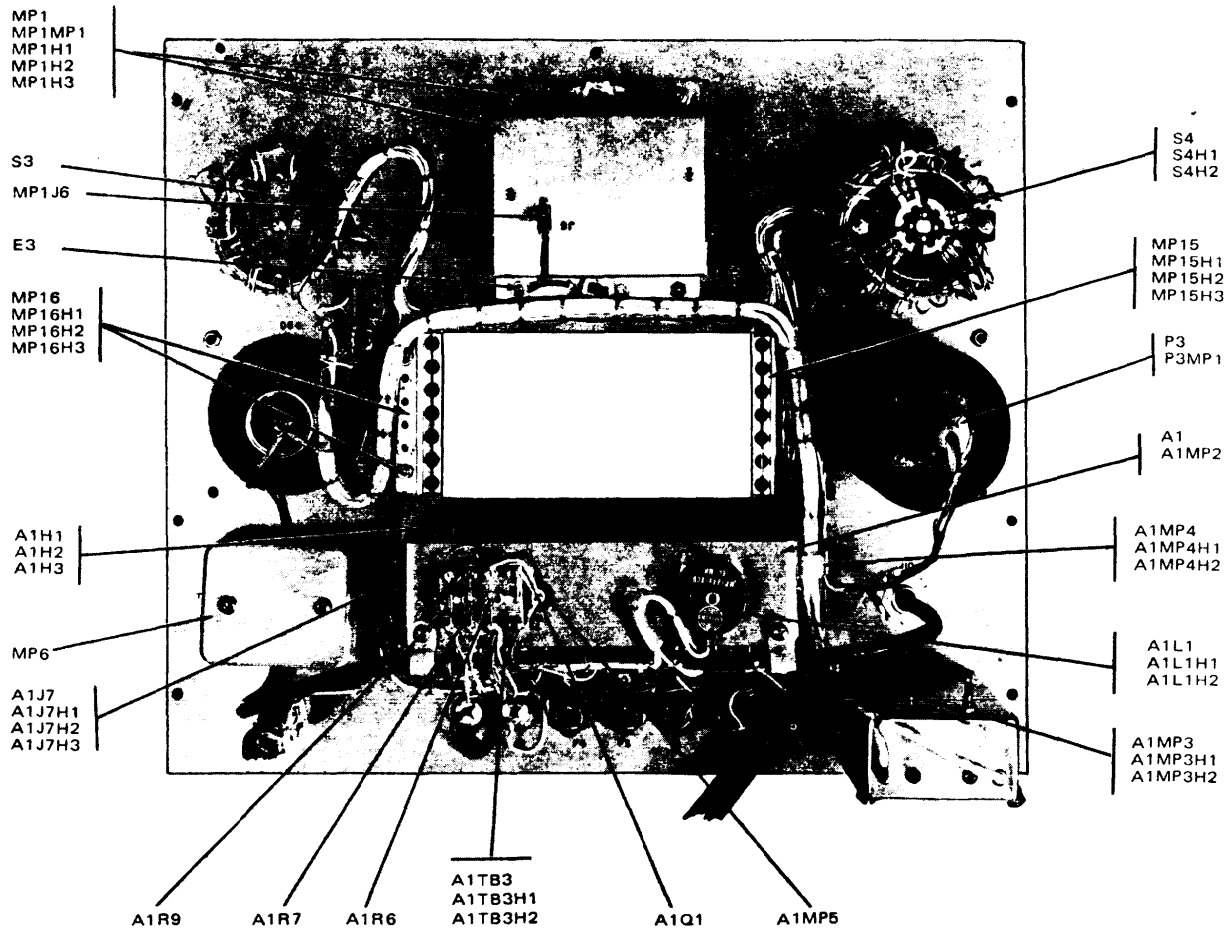

ASSEMBLY A3 FIGURE 7

EL6625-821-40P-7

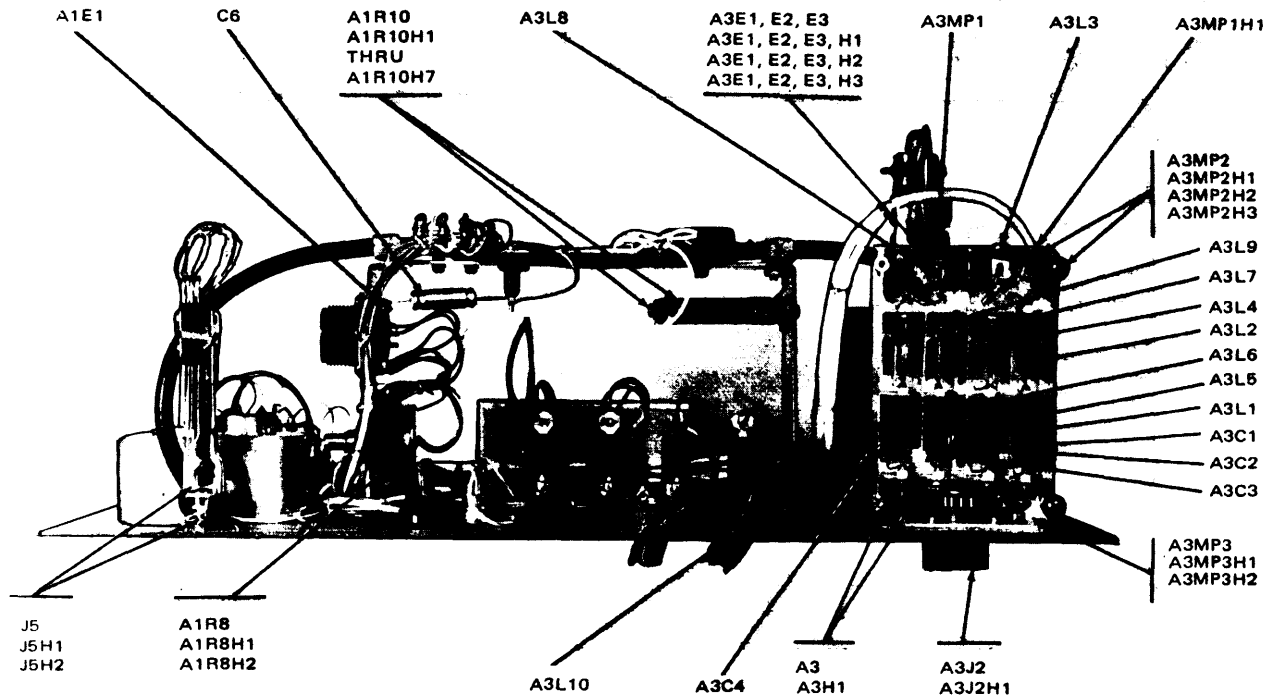

ASSEMBLY A3 FIGURE 8

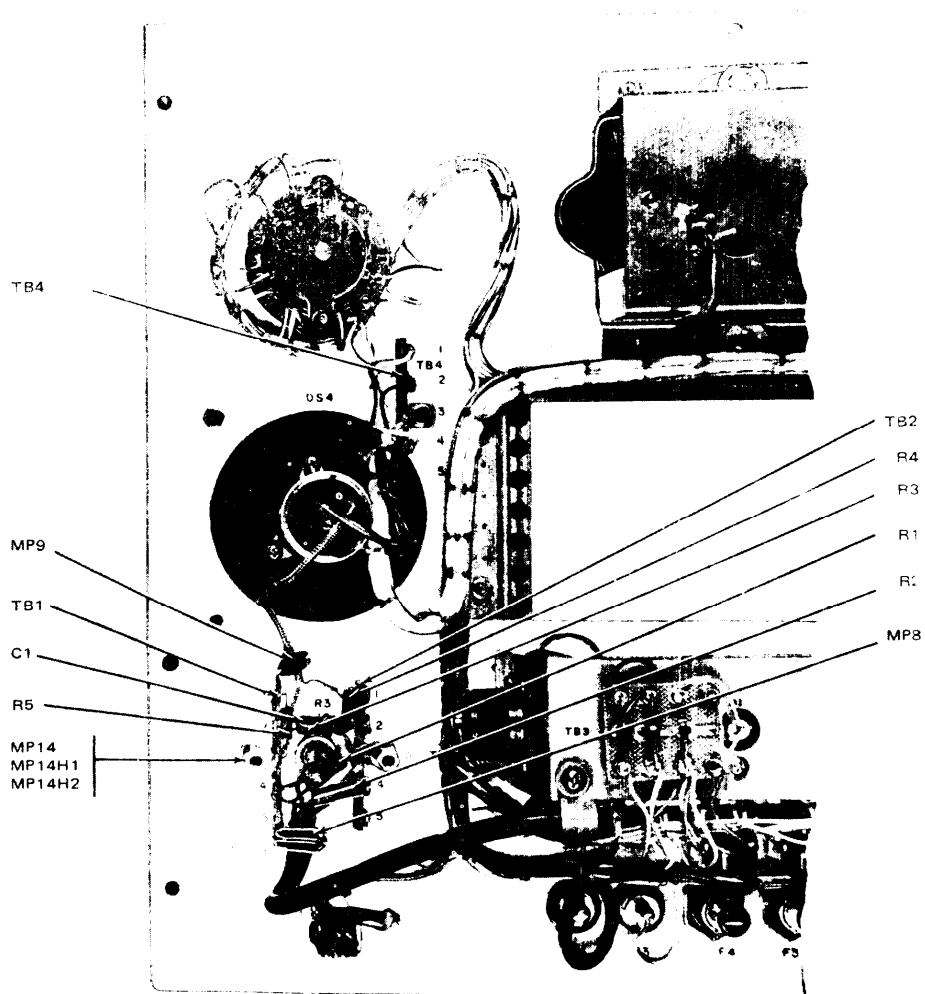

ASSEMBLY A3 FIGURE 9

EL 6625 821-40F 9

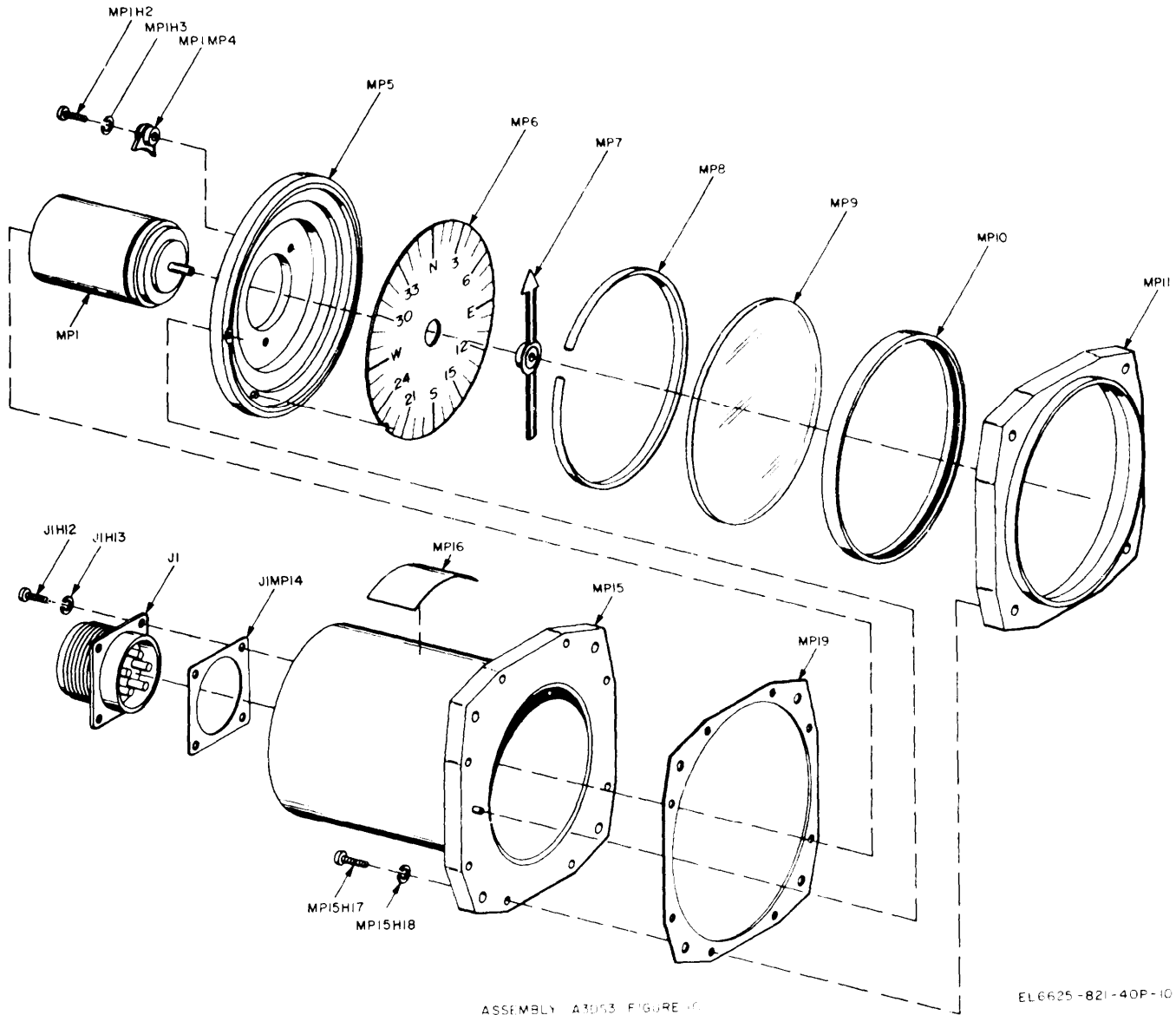

ASSEMBLY A3013 FIGURE 10

EL6625-821-40P-10

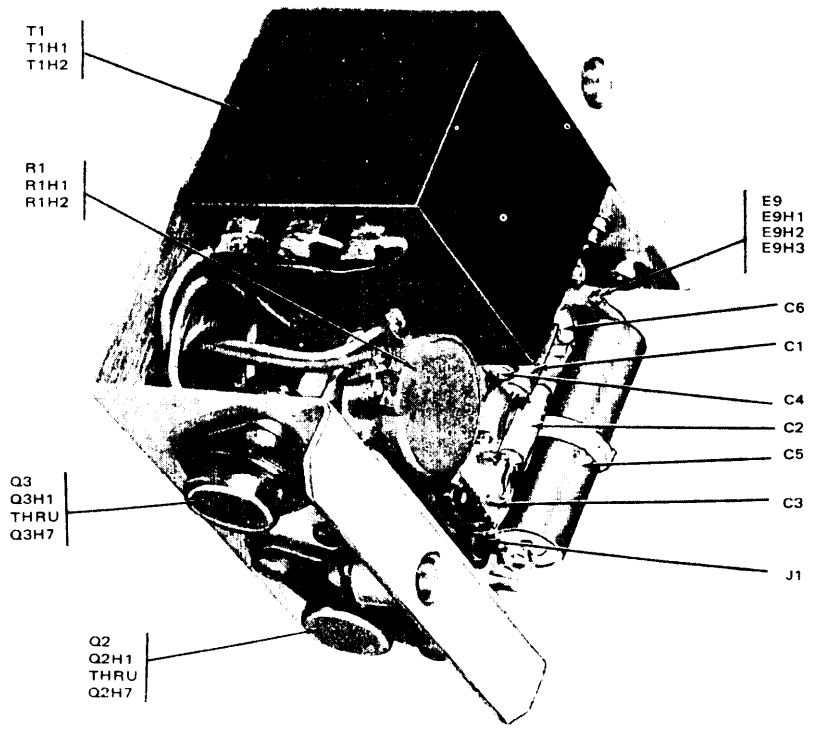

ASSEMBLY A3A2 FIGURE 11

EL6625-821-40P-11

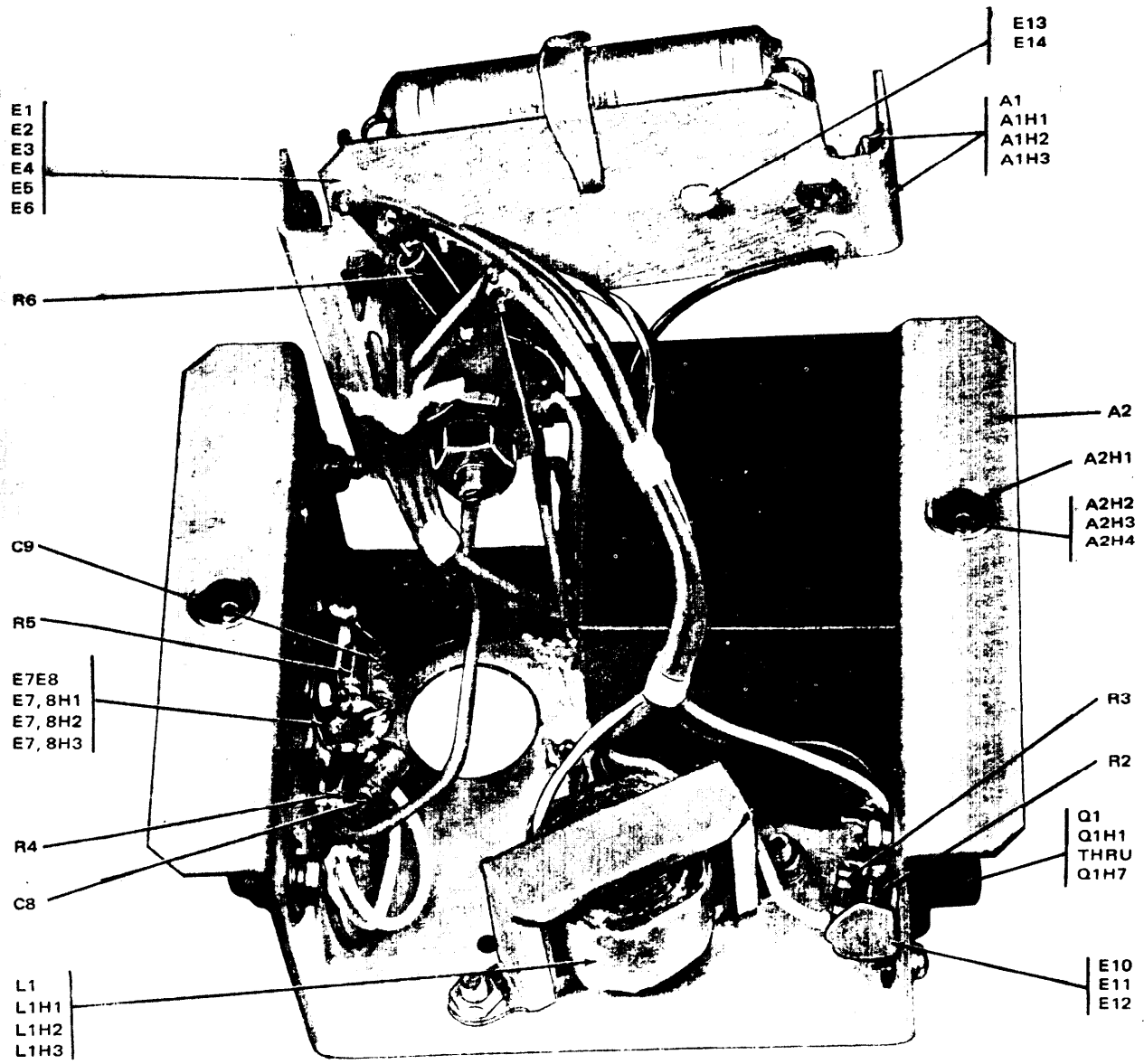

ASSEMBLY A3A2 FIGURE 12

EL6625-821-40P-12



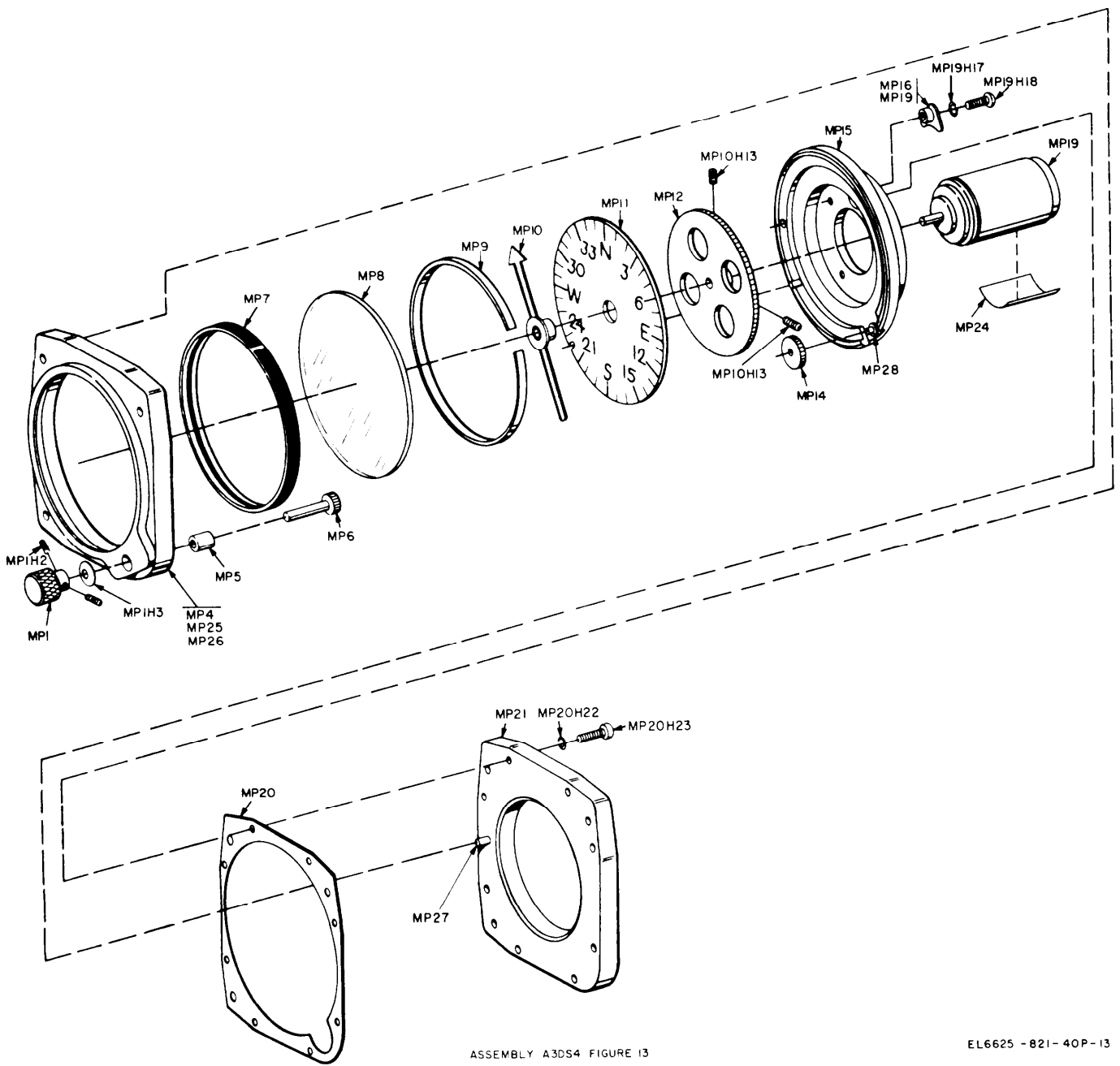

ASSEMBLY A3DS4 FIGURE 13

EL6625 - 821 - 40P - 13



By Order of the Secretary of the Army:

Official:

VERNE L. BOWERS  
*Major General, United States Army*  
*The Adjutant General*

CREIGHTON W. ABRAMS  
*General, United States Army*  
*Chief of Staff*

DISTRIBUTION:

To be distributed in accordance with DA Form 12-36A (qty rqr block No. 805) direct and general support maintenance requirements for AN/ARM-93.

RECOMMENDED CHANGES TO EQUIPMENT TECHNICAL PUBLICATIONS



THEN...JOT DOWN THE  
DOPE ABOUT IT ON THIS FORM.  
CAREFULLY TEAR IT OUT, FOLD IT  
AND DROP IT IN THE MAIL.

SOMETHING WRONG WITH PUBLICATION

FROM: (PRINT YOUR UNIT'S COMPLETE ADDRESS)

DATE SENT

PUBLICATION NUMBER

PUBLICATION DATE

PUBLICATION TITLE

BE EXACT PIN-POINT WHERE IT IS

PAGE  
NO.

PARA-  
GRAPH

FIGURE  
NO.

TABLE  
NO.

IN THIS SPACE, TELL WHAT IS WRONG  
AND WHAT SHOULD BE DONE ABOUT IT.

TEAR ALONG PERFORATED LINE

PRINTED NAME, GRADE OR TITLE AND TELEPHONE NUMBER

SIGN HERE

